

Thank you for your purchase.
Please read this manual carefully before use and keep it for future reference

1. Please note that the stand can carry a maximum device weight of 700g.
2. The adjustable device clamp can accommodate devices with a width range of between 100-270mm.

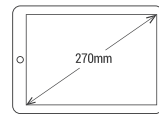

3. The attachment clip can be mounted onto desk edges with a thickness of up to 80mm.

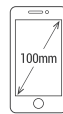
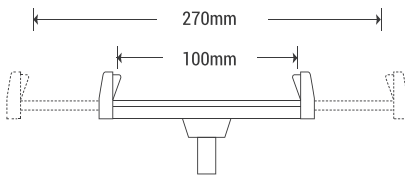
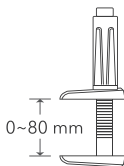

4. Please do not overtighten the attachment clamp.



5. For best stability, please twist the tube to an appropriate shape rather than using it in a straight line.
6. Please adjust the clip mount using both hands. Use your one hand to stabilise the tube by holding it above the desk clamp while using the other hand to adjust the positioning of the device clamp.