

maxx

Bosmaaier

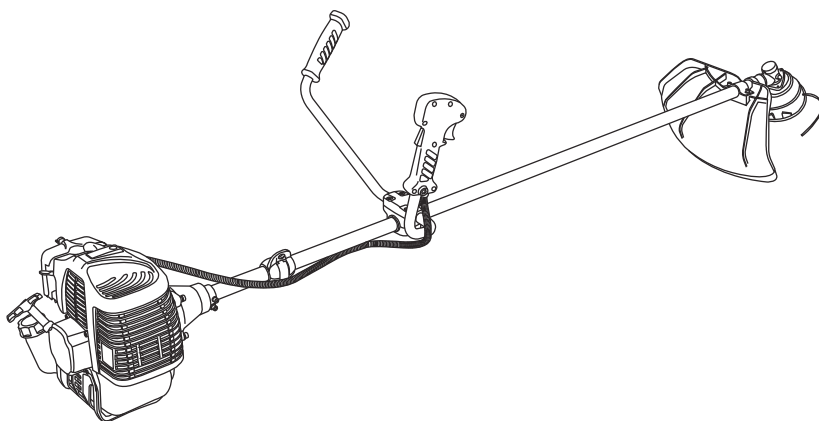

Model: 20575

DESCRIPTION OF SYMBOLS

Symbols are used in this manual to attract your attention to possible risks. The safety symbols and the explications which accompany them must be perfectly understood. The warning themselves do not prevent the risks and can not be a substitute for proper methods of avoiding accidents.



This symbol, before a safety comment, indicates a precaution, a warning or a danger. Ignoring this warning can lead to an accident for yourself or for others. To limit the risk of injury, fire or electrocution always apply the recommendations indicated.

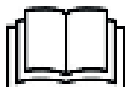

Before any use, refer to the corresponding paragraph in the present manual. Read the instruction handbook and follow all warnings and safety instructions



Conforms to relevant safety standards.



Keep all children, bystanders and helpers 15 meters away from the brush cutter.



The exhaust and other parts of the engine will get very hot during use, do not touch.



Gasoline is very flammable. Avoid smoking or bringing any flame or sparks near fuel.



Beware of thrown objects hit by cutting attachments. Never use without properly mounted blade guard.



The max speed marking.



Beware of foot injury by cutting attachment



Wear head protection, hearing protection and eye protection when using the device.



Wear robust footwear when using the device.



Wear protective gloves when using the device.



The part to refuel the "MIX GASOLINE" on fuel tank cap.

SAFETY INSTRUCTIONS

This appliance is not intended for use by persons (including children) with reduced physical, sensory or mental capabilities, or lack of experience and knowledge, unless they have been given supervision or instruction concerning use of the appliance by a person responsible for their safety.

Children should be supervised to ensure that they do not play with the appliance.

1) Training

- Read the instructions carefully. Be familiar with the controls and the proper use of the appliance.
- This product has been designed for use in cutting grass, and it should never be used for any other purpose.
- Never allow children or people unfamiliar with these instructions to use the appliance. Local regulations may restrict the age of the operator.
- Never mow while people, especially children, or pets are nearby.
- The operator or user is responsible for accidents or hazards occurring to other people or their property.
- Avoid running the engine indoors. The exhaust gases contain harmful carbon monoxide.

2) Preparation

- While cutting, always wear substantial footwear and long trousers.
- Do not operate the appliance when barefoot or wearing open sandals.
- Thoroughly inspect the area where the appliance is to be used and remove all stones, sticks, wires, bones, and other foreign objects.

- Before using, always visually inspect to see that the blades, blade bolts and cutter assembly are not worn or damaged. Replace worn or damaged blades and bolts in sets to preserve balance.
- On multi-bladed appliances, take care as rotating one blade can cause other blades to rotate.

3) Operation

- Operate only in daylight or in good artificial light.
- Avoid operating the appliance in wet grass, where feasible.
- Always be sure of your footing on slopes.
- Walk, never run.
- Exercise extreme caution when changing direction on slopes.
- Do not cutting excessively steep slopes.
- Use extreme caution when reversing or pulling the appliance towards you.
- Never operate the appliance with defective guards or shields, or without safety devices.
- Switch on the motor according to instructions and with feet well away from the blade(s).
- In this case, do not tilt it more than absolutely necessary and lift only the part which is away from the operator. Always ensure that both hands are in the operating position before returning the appliance to the ground.
- Do not put hands or feet near or under rotating parts.
- Never pick up or carry an appliance while the motor is running.
- Pull the spark from the socket:
 - whenever you leave the machine;
 - before clearing a blockage;
 - before checking, cleaning or working on the appliance;
 - after striking a foreign object. Inspect the appliance for damage and make repairs as necessary;
 - if the appliance starts to vibrate abnormally (check immediately).

4) Maintenance and storage

- Keep all nuts, bolts, and screws tight to be sure the appliance is in safe working condition.
- Check the grass catcher frequently for wear or deterioration.
- Replace worn or damaged parts for safety.

For rotary mowers, ensure that only replacement cutting means of the right type are used.

- Never store the equipment with petrol in the tank inside a building where fumes can reach an open flame or spark;
- Allow the engine to cool before storing in any enclosure;
- To reduce the fire hazard, keep the engine, silencer, battery compartment and petrol storage area free of grass, leaves, or excessive grease;
- If the fuel tank has to be drained, this should be done outdoors.

Special safety warning

1. Grip the handles of the brush cutter firmly with both hands. If you suspend the work, Place the throttle into the idling position.

2. Always be sure to maintain a steady, even posture while working.
3. Maintain the speed of the engine at the level required to perform cutting work and never raise the speed of the engine above the level necessary.
4. If the grass gets caught in the blade during operation , or if you need to check the unit of refuel the tank always be sure to turn off the engine.



5. If the blade touches a hand object like a stone immediately stop the engine and check it something is wrong with the blade. If so, replace the blade by new one .
 6. If someone calls out while working , always be sure to turn off the engine before turning around.
 7. Never touch the spark plug or plug cord while the engine is in operation .Doing so may result in being subjected to an electrical shock .
 8. Never touch the muffler ,spark plug or other metallic parts of the engine while the engine is in operation or immediately after shutting down the engine. Doing so may result in serious burns .
 9. When you finish cutting in one location and wish to continue work in another spot ,turn off the engine and turn the until as the blade faces away from your body.
10. Check the cutting attachment stop turning under the engine idle before start to use the machine.

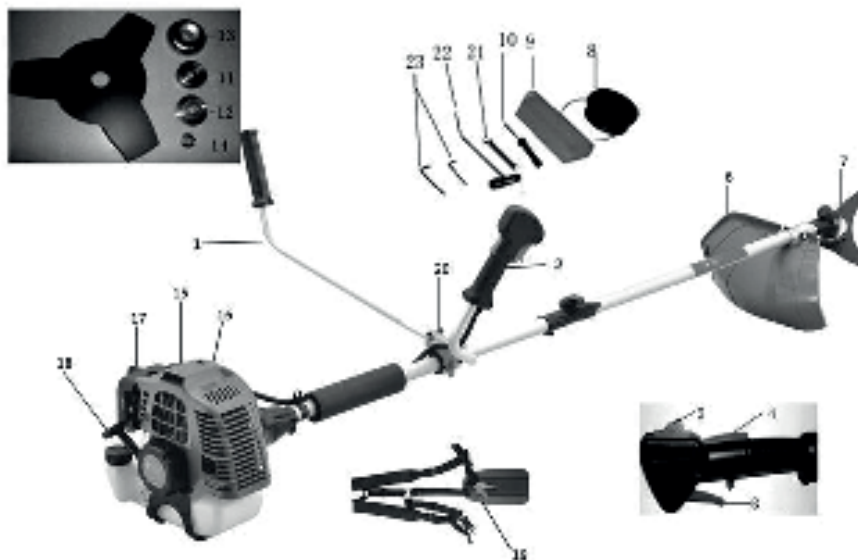

COMPONENT LIST

- | | |
|-------------------|-------------------|
| 1. Left handle | 2. Right handle |
| 3. Throttle lever | 4. Lock OFF lever |
| 5. Engine switch | 6. Safe guard |

7. Blade
9. Fuel bottle
11. Inner flange
13. Shield
15. Spark cover
17. Air filter
19. belt
21. Wrench
23. Hex wrench

8. Nylon cutter
10. screw driver
12. Outer flange
14. Nut
16. Engine
18. Recoil starter handle
20. Handle bracket
22. Hex

SPECIFICATIONS

Type	20575
Engine model	1E34F/1E36F/1E40F-5/1E44F/1E48F/1E51F
Engine displacement	25.4cc/32.6cc/42.7cc/51.7cc/62cc/72cc
Rated motor power	0.75kw/1.0kw/1.1kw/1.5kw/2.2kw/3.0kw
Volumes of fuel tank	800ml/900ml/1200ml/1200ml/1200ml/1200ml
Nylon Cutting width	440mm
Blade Cutting width	255mm
Cutting thickness	1.6mm/Ø2.5mm ²
Engine idle speed	3200/min
Maximum rotational speed	8500/min (brush cutter); 7000/min (grass trimmer)
Max. speed for cutting attachment	8000/min (brush cutter); 7500/min (grass trimmer)
Spark plug model	LD MB6A/L8RTF
Sound power level, L _{PA}	91.4dB(A) K=3dB
Sound power level, L _{WA}	118dB(A) K=3dB
Vibration level	8.1m/s ² K=1.5m/s ²

Intended use

This brush cutter has been designed for cutting grass. Any other use is not permitted.

The brush cutter is suitable for private use in the garden only, brush cutter for private use are those which are used for cutting grass in the garden, however not for cutting grass in public parks, playing fields or on farms or in forest.

Non-permitted users:

Persons who are not familiar with the operating manual, children, young people under the age of 16 as well as persons under the influence of alcohol, drugs or medication must not operate the unit.

Working hours for gasoline lawn mower

While it is permitted to use a brush cutter at any time, operators should always show due consideration to others living nearby.

Assembly

When assembling this machine, please follow the instructions for assembly printed.

1. Fit the shawl band to machine.

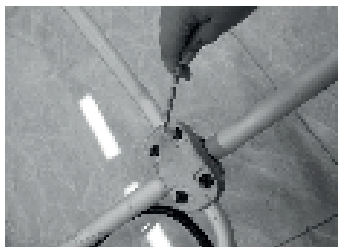

2. Assemble the handle on the machine. First release the inner hex screws, second take right and left handle on the centre of handle holder, last assemble the handle holder and tighten the inner screws enough.

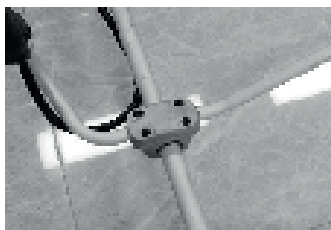
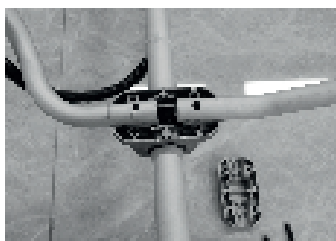
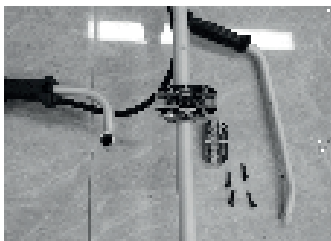

3. Assemble the safe guard. Release four nuts on safe guard bracket, and then fit safe guard as per below picture, tighten the nuts enough.

Warning! Use only original manufacturer's replacement parts, accessories and attachments. Failure to do so can cause poor performance, possible injury and may void your warranty. Never use the machine without the guard assembled!



4. Assemble the cutting head.

Release the nut. Line up the two holes of flange and shield, use one screw driver to hold the flange as below and turn the socket wrench clockwise, the nut will be released.



Fit the Nylon cutting head. Remove another shield after release the nut. Still hold the flange, take the Nylon cutting head on the shaft and rotate counter-clockwise, the Nylon cutting head is fitted.

Release the Nylon cutting head. Use screw driver to hold flange and then rotate the Nylon cutting head clockwise, it will be replaced.

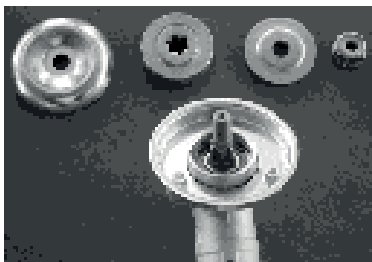

Fit the blade. Take the outer flange off after release the nut, then put the blade, outer flange, shield and nut according to priority as below picture. Note the blade rotation direction needs be same as below picture. Use screw driver to hold flange and tighten nut counter-clockwise, ensure the nut is tightened enough.

Release blade. Use screw driver to hold flange and release nut, the blade can be took off.

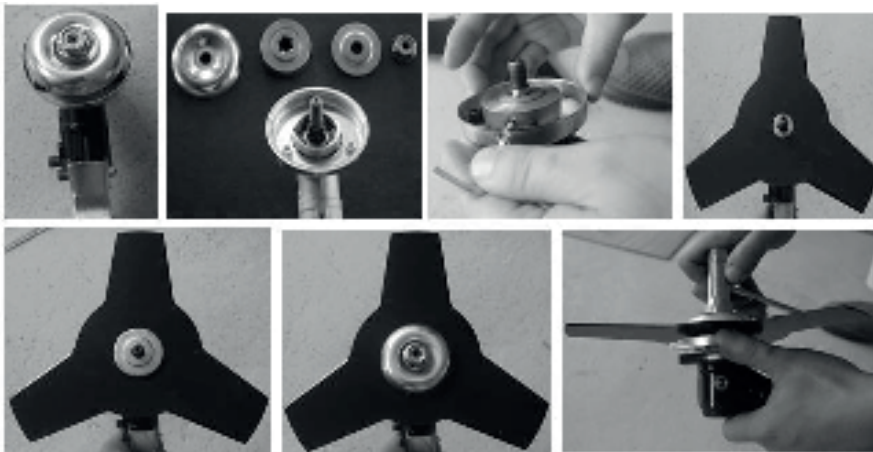

Warning!

Please make sure the cutting head has been assembled correctly before use!

Note: The packaging material is made of recycle materials. Dispose of packaging materials in accordance with regulations.

Filling with fuel



Danger of injury!

Fuel is explosive!

DANGER!

- Turn off and cool the motor down before filling the tank with fuel.
- You must observe all safety instructions relating to handling fuel.



Risk of device damage!

The device is supplied without motor or gearbox oil.

ATTENTION!

Before operating, you must fill it with fuel.

Never use oil for 4-cycle engine use or water cooled 2-cycle engine. It can cause spark plug fouling exhaust port blocking or piston ring sticking.

Mixed fuels, which have been left unused for a period of one month or more may clog the carburetor or result in the engine failing to operate properly. Put remained fuel into an airtight container and keep it in the dark and cool room.

Mix a regular grade gasoline (leaded or unleaded, alcohol-free) and a quality-proven motor oil for air-cooled 2 cycle engines.

RECOMMENDED MIXING RATIO
GASOLINE 25: OIL 1

Warning! Take care of the emission of exhaust gases.

Always shut off engine before fueling. Never add fuel to a machine with a running or hot engine. Take care of fire!

- Unscrew the tank cap and remove it.

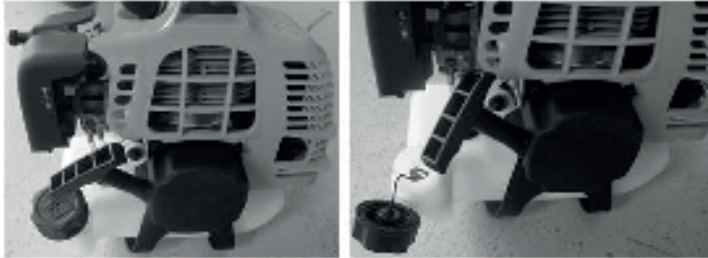

- Pour in the fuel carefully (max. 1200ml). Avoid spilling!



- Screw the tank cap on firmly by hand.

Draining fuel

- Hold a collection container beneath the fuel drain bolt.
- Unscrew the tank cap and remove it.

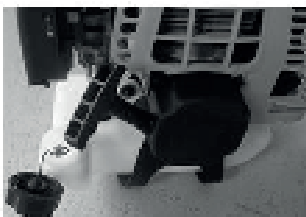

- Allow the fuel to run out completely.
- Screw the tank cap on firmly by hand.

Start on the unit

Do not start the unit until it has been completely assembled. Before switching on the unit, always checking the oil

Check before use!



DANGER!

Danger of injury!

Do not operate the device unless you did not find any faults. If a part has become defective, make sure to replace it before you use the device again.

Check the safe condition of the device:

- Check the device for leaks.
- Check the device for visual defects.
- Check that all parts of the device have been securely fitted.
- Check that all safety devices are in proper condition.



DANGER!

Danger of injury!

Before starting work, always check the ground and remove all objects which could be thrown by the device.

Once the machine has been set up properly, start the engine as follow:

1. Press the fuel pump more than 5 times.

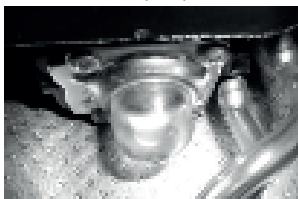

2. Turn the engine switch to the ON position.



3. Put the choke lever on the OFF position



4. Pull the recoil starter handle to start the engine, as following picture.



5. Wait a while adjust the choke leverl to ON position.



6. When the engine is running and idling. The throttle lever on handle is as below picture. First press the lock off lever and then switch the throttle lever on, the machine will be working.



7. If use Nylon cutter, before cutting, need bump to feed line on hardness area



8. If meet any problems, press the engine switch, the machine will stop running. If need stop cutting head working, release the throttle lever.



9. If the machine is hot, the throttle level can be adjusted to ON position directly when re start the machine.

Note: Do not start the motor in tall grass

Note: While mowing, lay the connection cable safely on footpaths and on areas which have already been mowed.

When the engine has been switched off, the cutter continues running for several seconds therefore do not close to cutting head of brush cutter until the cutter has come to a standstill!

Maintenance and care

Before performing any maintenance or cleaning work, Always turn off the engine.

1. Do not spray the unit with water. Ingress of water may damage the engine and electrical connection.
2. Clean the unit with a cloth, hand brush, etc.

Maintenance schedule			
	12 hours of use	24hours of use	36hours of use
Air filter	clean	clean	replace
Spark plug	check	clean	replace

Expert inspection is required:

- a) If the brush cutter strikes an object.
- b) If the motor stops suddenly
- c) If the blade is bent (do not align!)
- d) If the gears are damaged.

Replacing and resharpening the cutting blade at the end of the mowing season always resharpen the cutting blade or, if required, replace the cutting blade with a new one. Always have the cutting blade resharpened or replaced by a customer service centre (measurement of imbalance).

Unbalanced blades will cause the lawn mower to vibrate violently-risk of accident !

Change and clean the spark plug

- 1) Once the engine has cooled, remove the spark plug using the socket spanner supplied.
- 2) Clean the plug with a wire brush.
- 3) Using a feeler gauge; set the gap to 0.6-0.7 mm.
- 4) Install the spark plug carefully by hand, to avoid cross-threading.
- 5) After the spark plug is seated, tighten with spanner to compress the washer.

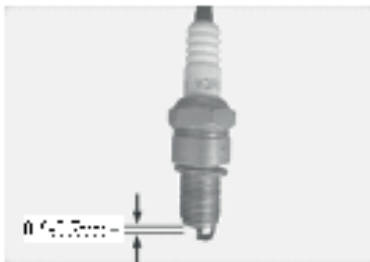

Clean the air filter

Unclip the air filter cover and remove the sponge filter element. To avoid objects falling into the air tank, replace the air filter cover. Wash the filter element in warm soap water, rinse and allow drying naturally.

Warning!

Never run the engine without the air filter element installed.

Storing the unit

After cutting, clean the unit thoroughly. Store the unit in a dry room allow the motor to cool down beforehand.

Troubleshooting

Before performing any maintenance or cleaning work, always turn off the engine and wait until the cutter has come to a standstill

1) Engine does not run:

- Reassemble the blade or Nylon cutter.
- check the fuel if spend the pack.

2) Engine power drops:

- Have cutting blade resharpened /replaced (customer service centre)

3) if the temperature of machines is too high :

- insure the machines have rest at regular time.

Faults which cannot be rectified with the aid of this table may be rectified by a specialist company only (customer service centre).





ONS MAXXTOOLS TEAM HELPT JE MET:

- Vragen over je bestelling
- Klachten
- Onderdelen en handleidingen

Heb je vragen of klachten contacteer ons en we helpen je graag verder.

NOTRE EQUIPE MAXXTOOLS VOUS AIDERA VOLONTIÈRE AUX CAS SUIVANTS:

- Questions sur votre commande
- Réclamations
- Pièces et manuels

Si vous avez des questions ou des plaintes, s'il vous plaît contactez-nous et nous serons heureux de vous aider.

UNSER MAXXTOOLS TEAM HILFT IHNEN GERNE BEI:

- Fragen zu Ihrer Bestellung
- Reklamationen
- Teile und Handbücher

Wenn Sie Fragen oder Beschwerden haben, wenden Sie sich bitte an uns. Wir helfen Ihnen gerne weiter.

OUR MAXXTOOLS SERVICE TEAM HELPS YOU WITH:

- Questions about your order
- Complaints
- Parts and manuals

If you have any questions or complaints, please contact us and we will be happy to help you.



TELEFOONSERVICE:

+32 (0) 11 191391

Maandag tot zaterdag - 9u.-18u.

De telefoon kosten kunnen variëren afhankelijk van uw mobiel abonnement.

ASSISTANCE TÉLÉPHONIQUE:

+32 (0) 11 191391

Du lundi au samedi de 9h à 18h

Les frais de téléphone peuvent varier en fonction de votre abonnement mobile.

TELEFON-SERVICE:

+32 (0) 11 191391

Montag bis Samstag von 9 bis 18 Uhr

Die Telefonkosten können je nach Mobilfunkabonnement variieren.

TELEPHONE SUPPORT:

+32 (0) 11 191391

Monday to Saturday - 9 am - 6 pm

Phone charges may vary depending on your mobile subscription.

Maxxtools

Grotstraat 36 - 3990 Peer

info@maxxtools.be

www.maxxtools.be