

BRASQ®

USER MANUAL

F400

STRUCTURE

1. FRONT GUARD
2. BLADE NUT
3. BLADE
4. GUARD MOUNTING NUT
5. BACKGUARD
6. MOTOR SHAFT
7. MOTOR HOUSING
8. OSCILLATION KNOB
9. STAND
10. SPEED SWITCH
11. BASE
12. SCREWS

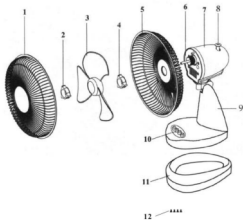

SPECIFICATIONS:

PLUG TYPE	VOLTAGE	FREQUENCY	POWER
CLASS 2 3AMP FUSE	220-240V ~	50/60Hz	40W

ASSEMBLY

1. Fix the base into the stand with the 4 screws.
2. Loosen Guard Mounting Nut from the Motor Housing.
3. Position rear guard firmly to motor housing and then fasten by turning guard mounting nut clockwise tightly.
4. Push along the motor shaft and fasten firmly with the blade.
5. Hang the front guard to Rear Guard with the position fixer provided at the rim of Guard and then fix together with clips provided.

OSCILLATION CONTROL

1. Press the buttons on the fan body to turn on or off the fan and to switch the speed: 0-stop; 1-low speed; 2-medium speed; 3-high speed.

2. Oscillation : Push the oscillation knob to oscillate. Pull the oscillation knob to stop
3. Pitching : To control the pitching, push the fan guard up and down to the desired angle.

CAUTION

- Incorrect operation and improper use can damage the appliance and cause injury to the user.
- The appliance may be used only for its intended purpose. No responsibility can be taken for any possible damage caused through incorrect use or improper handling.
- Before connecting the appliance to the power source, check that the current and power match those given on the rating label.
- Do not put the appliance or the plug in water or any other liquid. However should the appliance accidentally fall into water, make sure your hands are dry & unplug the appliance immediately. Discard the appliance once safe.
- Never attempt to open the housing yourself.
- Do not place any kind of object into the inside of the housing.
- Do not use the appliance with wet hands, on a damp floor or when the appliance itself is wet. - Do not touch the plug with wet or damp hands.
- Check the cord and the plug regularly for any possible damage. If the cord or plug is damaged, it must be replaced by the manufacturer or a qualified person in order to avoid a hazard.
- Do not use the appliance if it is dropped or otherwise damaged or if the cord or plug are damaged.
- In the case of damaged, take the appliance to the authorized service center for examination and repair if necessary.
- Never attempt to repair the appliance yourself. This could cause an electric shock.
- Do not allow the cord to hang over sharp edges and keep it well away from hot objects and naked flames. Remove the plug from the socket only by holding the plug.
- Make sure that there is no danger that the cord or extension cord can inadvertently be pulled or cause anyone to trip when in use.
- If an extension cord is used it must be suited to the power consumption of the appliance, otherwise overheating of the extension cord and /or plug may occur.
- This appliance is not suitable for commercial use nor for use in the open air.
- Never leave the appliance unattended while it is in use.