

LASER TONER CARTRIDGE INSTRUCTION

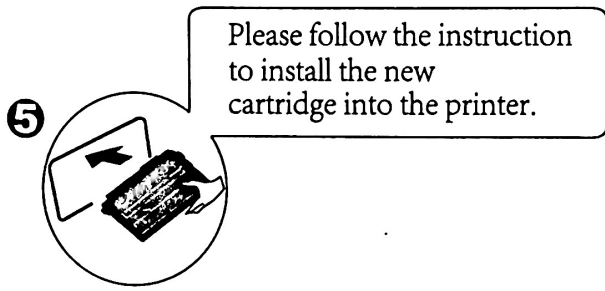
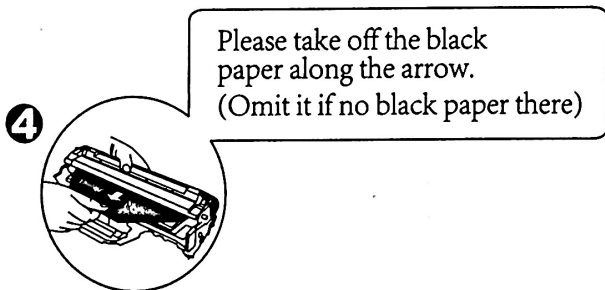
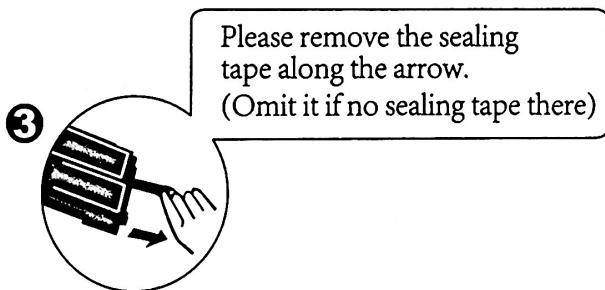
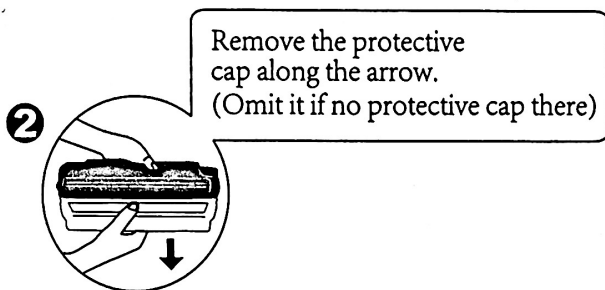
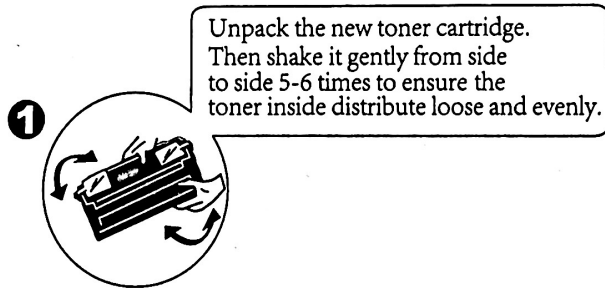

Notes and Cautions

- 1.Environment requirement :Generally speaking, temperature for installation and usage of laser toner cartridge is 10-30°C and relative humidity is 20-80%.If this can't be achieved, the printout will probably not be good.In this case, please put the machine and cartridge together under the temperature and humidity required for at least 2 hours before proceeding printing. Otherwise there will be bad printout.
- 2.Media requirement: Please select suitable media for printing. Don't use damaged, over-thick, too hard paper or paper with staple, for they will damage the OPC and lead to white line, deformed letter or gray background.
- 3.The toner cartridge is equipedwith IC chip or fuse. When the prompt "TONER EMPTU" appears,it indicates that the Icchip or fuse will be expired and the toner is going to be exhausted,but 200-400 more pages can be printed.
- 4.OPC is vital to laser toner cartridge. Don't touch it with hand nor expose it to direct sunshine. Otherwise it will reduce lifetime of OPC and cause bad printout.
- 5.When using special media, please use manual function for paper feeding and adopt the nearest output track, which could shorten paper running track to avoid paper jam.
6. When replacing the laser toner cartridge, it is better to use dust collector to clean the place where the toner cartridge loaded and use some soft cloth to clean away the paper scrap and toner in the paper track. Please clean the exposed electronic sensor with alcohol to avoid pale printing caused by bad contact.
- 7.At the beginning of printing some occurrence like obscure image or pale printing may happen. This may be due to the humidity of machine, toner hopper or paper. This phenomenon could be eliminated by continuously printing for more than 10 pages.
8. When "Toner Low" appeared, there will be pale printout. Shake the cartridge or pat toner hopper, possibly you may print 40-50 pages more.