

TECHNICAL SPECIFICATIONS

Charge with:	
Wall socket (via battery charger)	Charging time approx. 2.5 hours
29 W SunPower solar panel	Charging time approx. 15 hours
Input	
23V ~ 75V DC input with 2 pin GX16 DC-connection	
Outputs	
AC outlet, 230VAC, 50Hz, 250W continuous, 500W peak, pure sine wave	
12V car plug up to 12.5A (150W)	
1 x USB 5V, 2.4A 1 x USB Quick Charge 3.0	
Battery	
Battery type	NMC
Battery capacity	259 Wh (14.8V 17.5 Ah)
Battery life	Approx. 5 years (1.500 charge cycles, 80% DOD)
General	
Weight	6 kg
Dimensions	57 x 28 x 6.5 cm
Warranty	12 months
Certifications	CE
Optimal operating temperature	0-40° C
Protections:	
Battery voltage low	Automatic
Battery voltage too full	Automatic
Overload	Automatic
Short circuit	Automatic
Overtemperature	Automatic
Overheating	Turn off the power switch and put the Mobisun Pro in a cooler environment. Wait 5 to 10 minutes and turn on the Mobisun Pro again.

USE CASES

- Small electrical appliances
- TV
- Laptop
- Soundsystem
- Refrigeration Equipment
- Electric bike
- Sander
- Lighting
- Slowcooker
- Slowjuicer
- 12V coffee machine
- Tablet
- Smartphones
- etc.



5V light:
50+ hours



Charge
smartphone:
+30 times



Charge laptop:
5+ times



Watch TV:
10+ hours



Caution: risk of electric shock



Avoid exposure to water



Keep out of reach of children



Mobisun Pro

User manual

Mobisun Pro

User manual for correct use

Overview

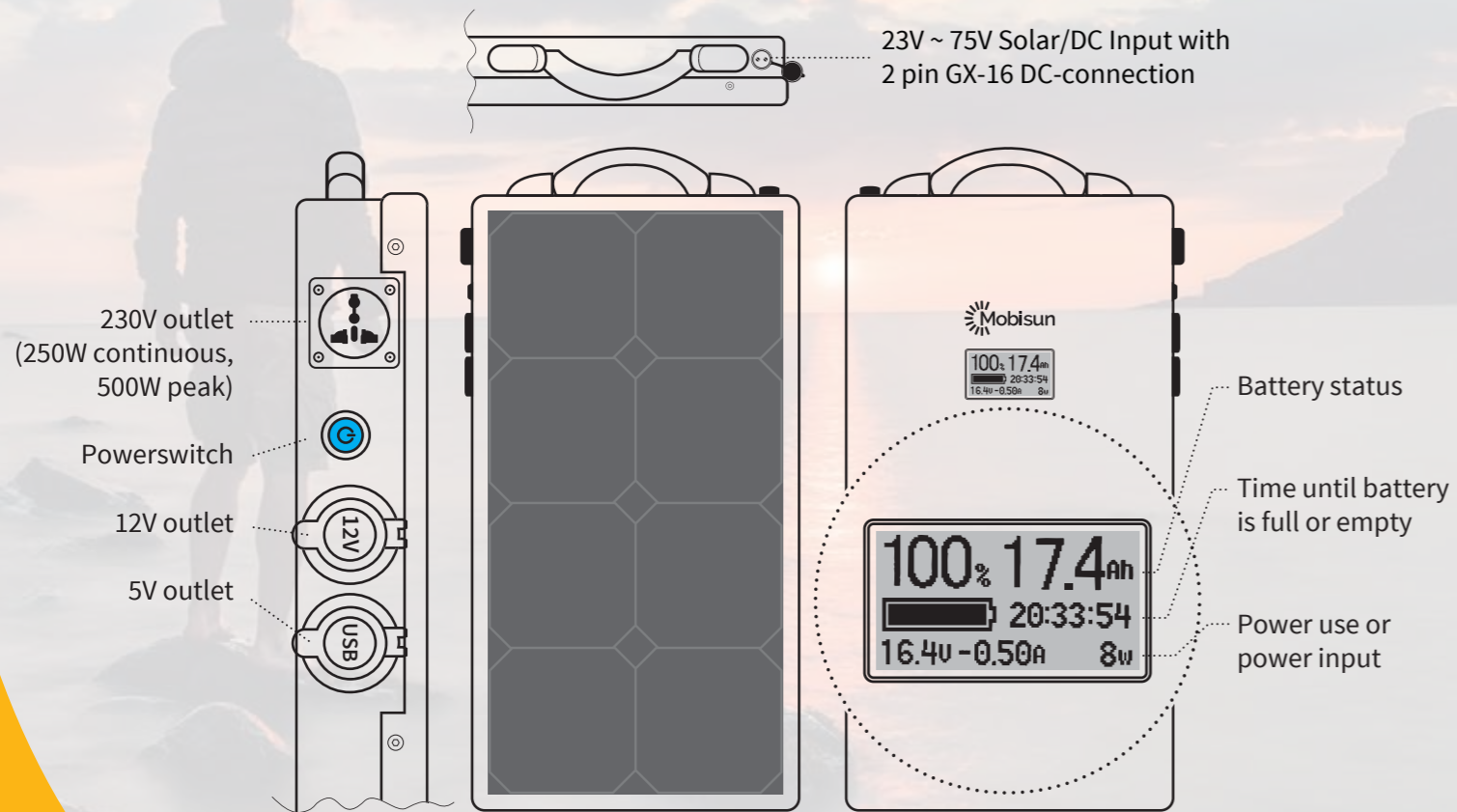

Charging

During charging the LED display on the back begins to flash. Electrical devices can be powered during charging.

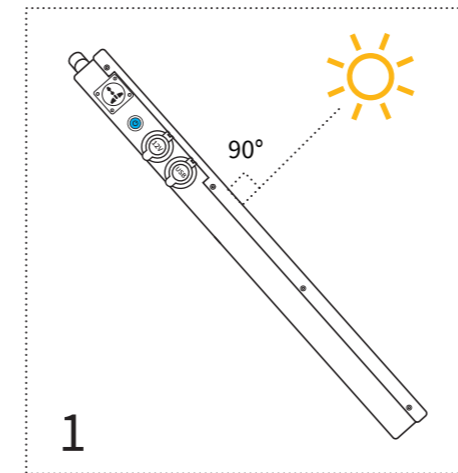

1. The integrated battery is automatically charged by placing the solar panel into direct sunlight. Place the panel in a right (90°) angle towards to sun for maximum charge efficiency.

2. Charge the integrated battery in 2.5 hours with the supplied adapter. The DC input can also be connected to an external 23V Mobisun solar panel (60W or 100W). This will reduce the solar charging time to 3 - 5 solar hours.

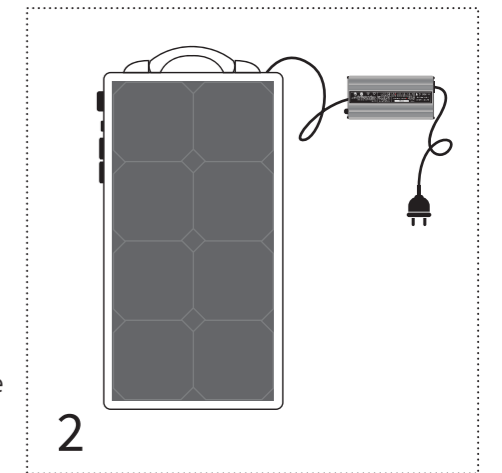

Usage

The powerswitch (blue light on) activates 3 functions:

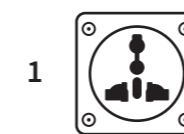

230V AC output

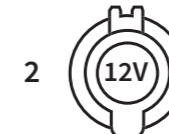

12V DC output



5V USB output

Turn the power switch off (blue light off) when no power is needed. In the off position charging in the sun or via the adapter is still possible.