

USER GUIDE

Indy ANC

Auto Pair Mode

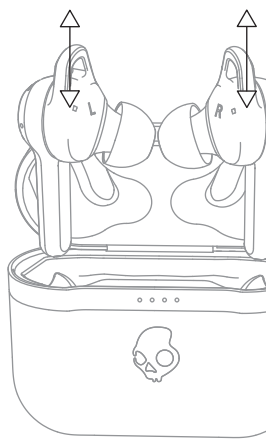

Pairing Mode Mode Coupilage Modo De Vinculacion Modaltà Di Accoppiamento...

Auto Power - On

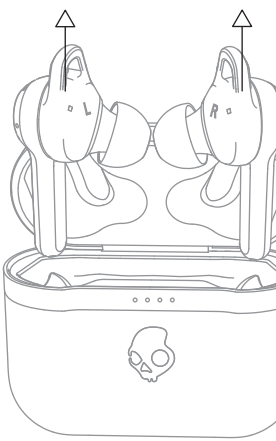

Power - On On Encendido Accensione Ligar Ein Aan-

Auto Power - Off

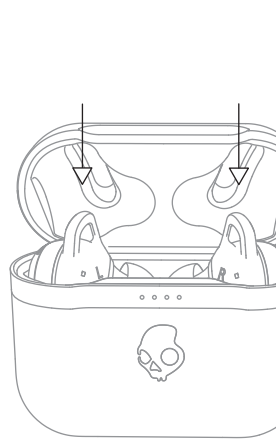

Power - Off Off Apagado Spegnimento Desigar Aus Uitzetting Sluk For Strom...

Charge Earbuds

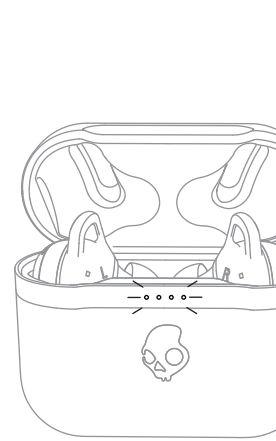

Charge Earbuds Rechargez Les Ecouteurs Audifonos De Carga Carica Gli Auricolari...

Charge Case

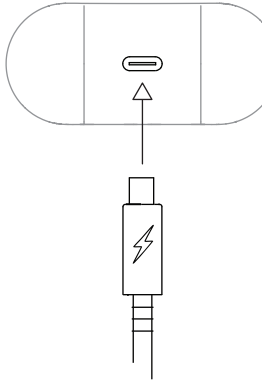

Charge Case Rechargez L'étui Estuche De Carga Carica La Custodia...

Pairing Mode

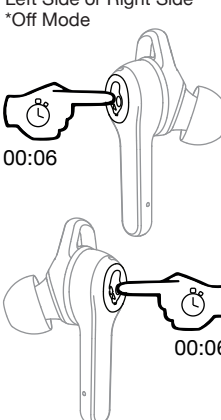

Pairing Mode Mode Coupilage Modo De Vinculacion Modaltà Di Accoppiamento...

Pair New Device

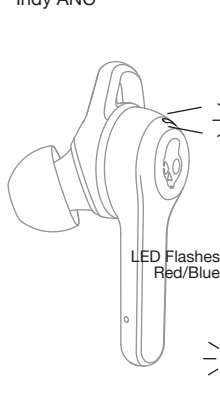

Pair New Device Coupler Nouvel Appareil Vincular Nuevo Dispositivo...

Power - On

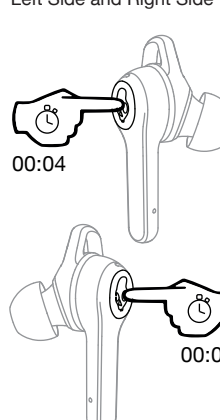

Power - On On/Off Encendido Accensione Ligar Ein Aan-

Power - Off

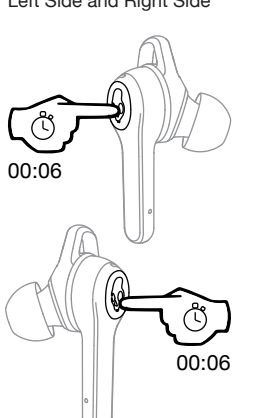

Power - Off Off Apagado Spegnimento Desigar Aus Uitzetting...

Play/Pause

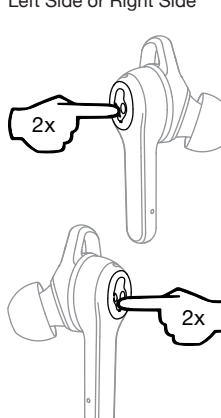

Play/pause Lecture/pause Reproducir/pausar Riproduci/pausa...

Track Forward

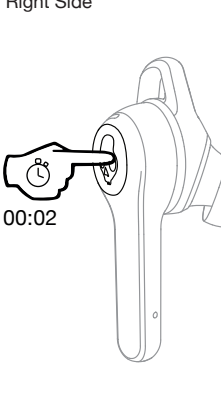

Track Forward Piste Suivante Adskelvar Brano Successivo...

Track Back

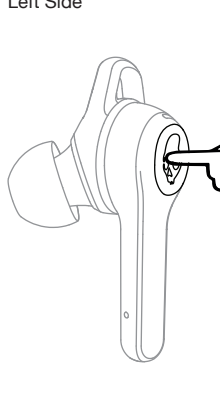

Track Back Piste Précédente Retorcedor Brano Precedente...

Volume Up

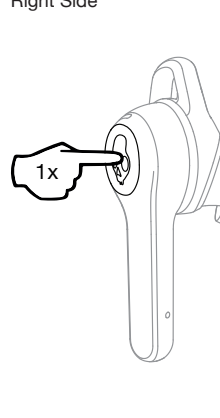

Volume Up Volume + Sub+ Volumen Aumento Volume...

Volume Down

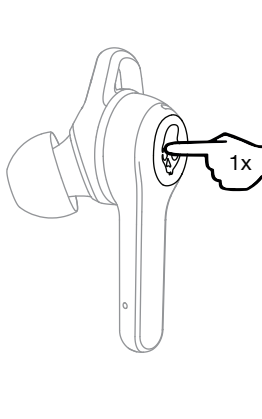

Volume Down Volume - Bajar Volumen Reduccion Volume...

Answer/End

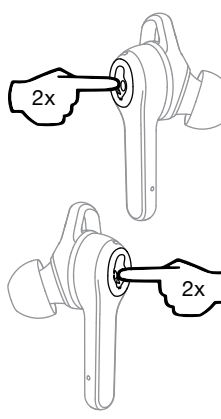

Answer/End Répondre/fin Responder/colgar Rispota/line...

Activate Voice Assistant

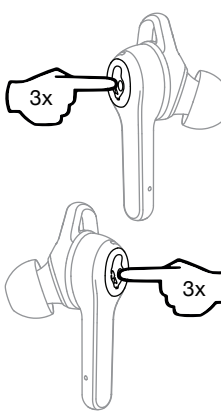

Activate Voice Assistant Activer l'assistant vocal Activar el asistente de voz...

Clear Paired Device

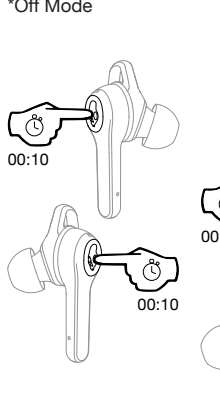

Reset Device Réinitialiser l'appareil Reinitializar el Dispositivo...

Pair Tile™

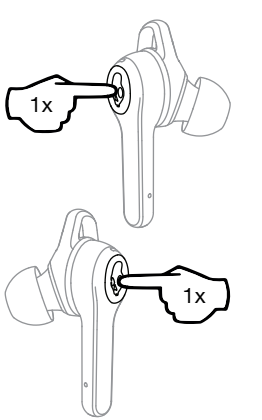

Pair Tile™ Associer Tile™ Emparejar Tile™ Abbinare Tile™...

3 EQ Modes

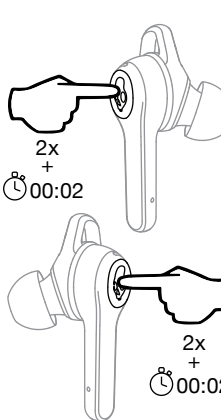

Change equalizer modes Changez les modes d'égaliseur Cambiar modos de equalizador...

Noise Cancellation

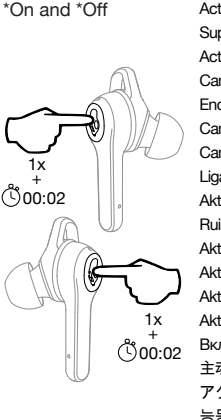

Active Noise Cancelling (ANC) On/Off Suppression Active du Bruit (SAB) Activer/Désactiver...

Ambient Mode

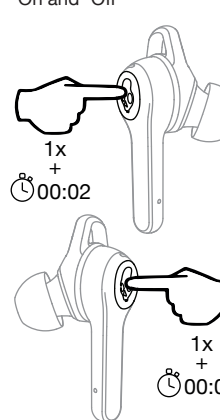

Ambient mode Mode ambiant Modò ambiente Modaltà ambiente...

FCC Compliance Statement

This device complies with Part 15 of the FCC Rules. Operation is subject to the following two conditions: (1) this device may not cause harmful interference...

L'émetteur/récepteur exempt de licence

Cet appareil est conforme aux CNR d'innovation, Sciences et Développement économique Canada applicables aux appareils radio exempts de licence. L'exploitation est autorisée aux deux conditions suivantes: (1) l'appareil ne doit pas produire de brouillage...

ISED SAR Compliance Statement

This equipment complies with ISED radiation exposure limits set forth for an uncontrolled environment. End user must follow the specific operating instructions for satisfying RF exposure compliance.

Americas Skullcandy, Inc. 6301 N Landmark Dr. Park City, UT 84208 U.S.A. Skullcandy.com Europe Skullcandy Europe BV Postbus 425 5500AK, Veldhoven Nederland Skullcandy.eu Mexico Skullcandy Mexico S de RL de CV Aristoteles 218 Platanos IV Sección, Miguel Hidalgo 11550, Mexico City, Mexico Skullcandy.mx Canada Skullcandy Canada ULC 329 Railway St., Unit 205 Vancouver, BC, V6A 1A4 Canada Skullcandy.ca Japan/日本 Skullcandy Japan 株式会社 スカスカンディ 東京都中央区神楽坂 5-17-11 パールサイドオーサカビル Skullcandy Japan カスタマーサービス 商品についてのお問い合わせはこちら Skullcandy.jp EN Contains Li-ion battery. Battery must be recycled or disposed of properly. FR Contient une batterie Li-ion. La batterie doit être recyclée ou jeté correctement. ES Contiene una batería Li-ion. La batería debe ser reciclada o desechada adecuadamente. Hardware Version: V1.4 Software Version: V3.0 R-C-Sku-S21YW EN Made in China. FR Fabriqué en Chine. ES Hecho en China. ZH 中国制造. Indy ANC MODEL : S21YW FCC ID : Y22-S21W IC : 1468A-S21W

Questions Visit: www.skullcandy.com Si vous avez des questions, allez sur : www.skullcandy.com Si tienes dudas, visita: www.skullcandy.com Domande Visitare il sito: www.skullcandy.com Fragen besuchen: www.skullcandy.com Voor vragen bezoek: www.skullcandy.com For spørgsmål, besøg: www.skullcandy.com Eelnu y aas vastamiseks võtkoos, poselvitte: www.skullcandy.com 如有任何問題, 請向: www.skullcandy.com 문의 사항: www.skullcandy.com 如有任何問題, 請向: www.skullcandy.com 如有任何問題, 請向: www.skullcandy.com

SIMPLIFIED EU DECLARATION OF CONFORMITY Hereby, Skullcandy International GmbH declares that the radio equipment type [Model: S21YW] is in compliance with Directive 2014/53/EU. The full text of the EU declaration of conformity is available at the following internet address: skullcandy.eu/product-documents

DECLARACIÓN DE CONFORMIDAD SIMPLIFICADA DE LA UE Por la presente, Skullcandy International GmbH declara que el tipo de equipo de radio. [Modelo: S21YW] cumple con la Directiva 2014/53/UE. El texto completo de la declaración de conformidad de la UE está disponible en la siguiente dirección de Internet: skullcandy.eu/product-documents

VEREENVOUDIGDE EU-CONFORMITEITSVERKLARING Hierbij verklaart Skullcandy International GmbH dat het type radio-apparaattype [Model: S21YW] voldoet aan Richtlijn 2014/53/ EU. De volledige tekst van de EU-conformiteitsverklaring is beschikbaar op het volgende internetadres: skullcandy.eu/product-documents

YKSINKERTAINEN EU- N VAATIMUSTENMUKAISUUSVAKUUTUS Täällä tavoin Skullcandy International GmbH vakuuttaa, että radiolaitteen tyyppi [Model: S21YW] on direktiivin 2014/53/ EU mukainen. EU- n vaatimustenmukaisuusvakuutuksen koko teksti on saatavilla seuraavassa Internet- osoitteessa: skullcandy.eu/product-documents

DICHIAZIONE DI CONFORMITÀ UE SEMPLIFICATA Con la presente, Skullcandy International GmbH dichiara che il tipo di apparecchio radio [Modello: S21YW] è conforme alla Direttiva 2014/53/UE. Il testo completo della dichiarazione di conformità UE è disponibile al seguente indirizzo internet: skullcandy.eu/product-documents

DECLARAÇÃO DE CONFORMIDADE DA UE SIMPLIFICADA Por este meio, a Skullcandy International GmbH declara que o tipo de equipamento de radio [Modelo: S21YW] está em conformidade com a Diretiva 2014/53/UE. O texto integral da declaração UE de conformidade está disponível no seguinte endereço da Internet: skullcandy.eu/product-documents

EN Contains Li-ion battery. Battery must be recycled or disposed of properly. FR Contient une batterie Li-ion. La batterie doit être recyclée ou jeté correctement. ES Contiene una batería Li-ion. La batería debe ser reciclada o desechada adecuadamente. Hardware Version: V1.4 Software Version: V3.0 R-C-Sku-S21YW

