

ASSEMBLY INSTRUCTIONS

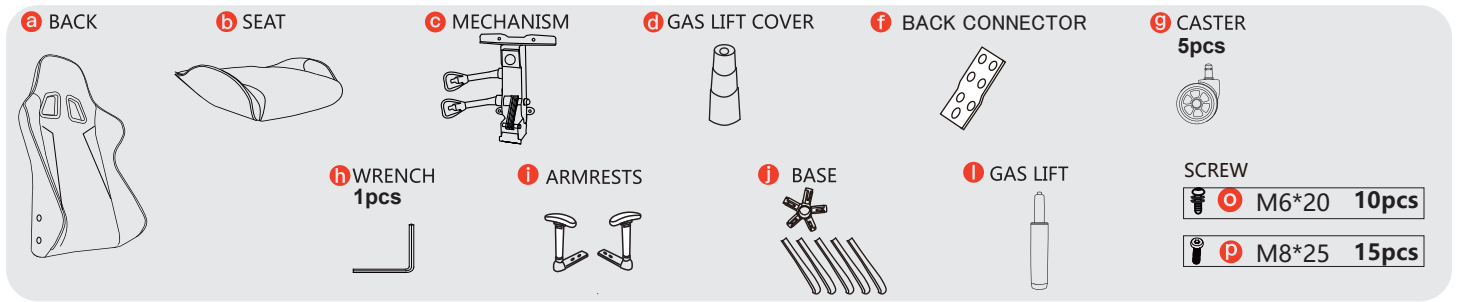

1 Insert the legs into the base center and fix them with M6*20 screws.

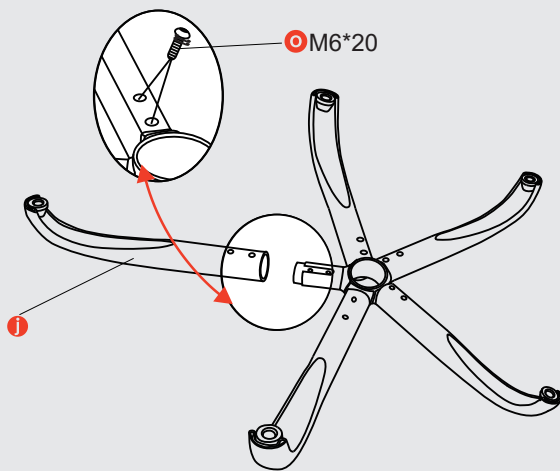

2 Place the base upside down and insert the casters into the bottom of the base.

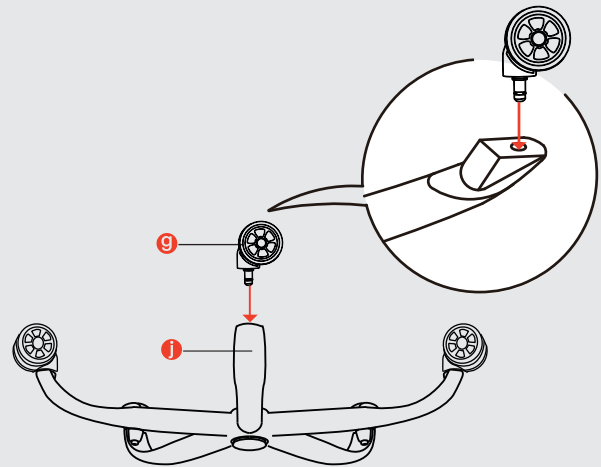

3 Install gas lift and insert gas lift cover.

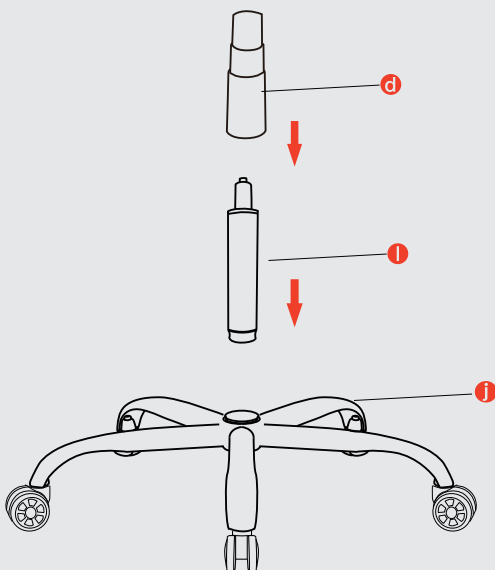

4 Install the mechanism and armrests.

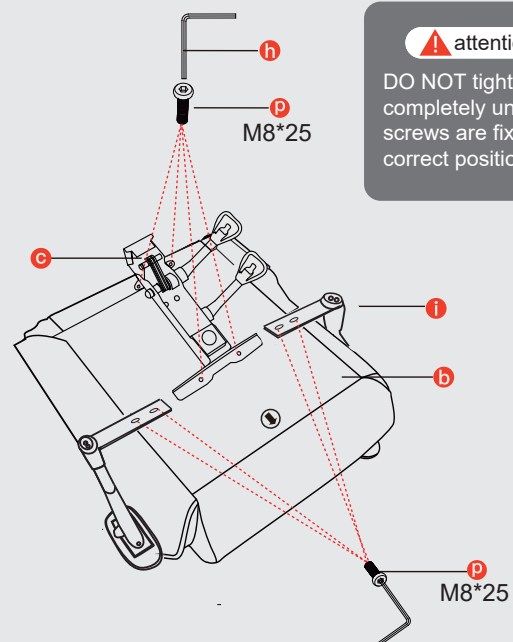

5 Place the seat on the gas lift.

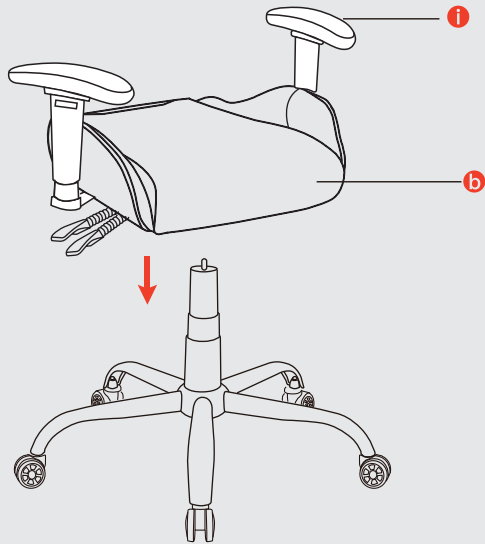

6 Open the Velcro on the lower back of **a**, secure the **f** with M8*25 Screws, then attach the Velcro.

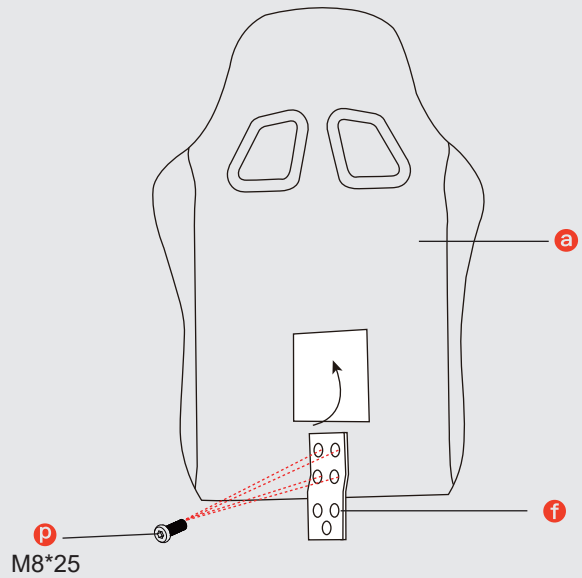

7 Position the **a** with the back of the **b**, align to holes. Using M8*25 Screws tighten securely.

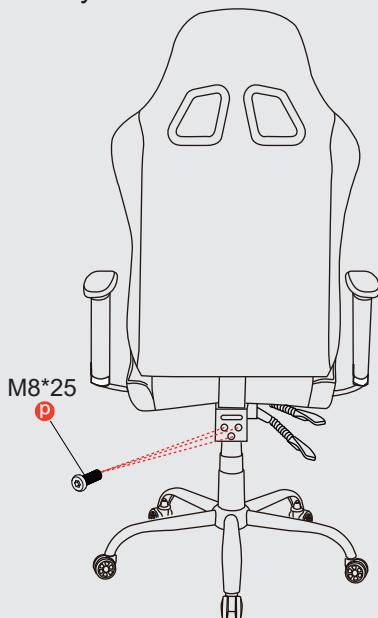

8



NOTE: Assembly is recommended to be carried out by two people.
Preventing the screws from loosening requires tightening after using a period of time.

! Only trained personnel may replace or repair seat height adjustment components with energy accumulators.