

YES!™

LASER HAIR REMOVER

user guide



the beauty specialists

WARNINGS

- **Please read all instructions thoroughly before using the product and retain for future reference.**
- This appliance can be used by children aged 8 years and above and persons with reduced physical, sensory or mental capabilities or lack of experience and knowledge if they have been given supervision or instruction concerning the use of the appliance in a safe way and understand the hazards involved. Children shall not play with the appliance. Cleaning and maintenance shall not be made by children without supervision.
- This appliance is only to be used with the mains adapter supplied.
- This appliance must only be supplied at safety extra low voltage corresponding to the marking on the appliance.

WARNINGS

- If any part of the mains adapter or cord are damaged, discontinue use.
- Not suitable for Afro-Caribbean, black skin complexions or for Grey Hair. See “Skin Types and Power Level Guide” section.
- Laser hair removal should not cause discomfort, you may feel individual hairs being treated, which is like a mild pin prick, and a slight warming of the area.
- If you feel any discomfort or soreness the setting may be too high.
- Inbuilt safety features protect the eye being exposed to the laser, however, never aim the unit at or near eyes.

WARNINGS

- Do NOT use near flammable materials.
- Reflection Hazard: Please remove all jewellery in the vicinity of the treatment area before use.
- Do not treat the same hair repeatedly in any one session.
- Do not use after drinking alcohol or if you are feeling unwell or fatigued.
- Do not treat the following areas: tattoos, permanent make-up, pimples, warts, hair on black spots or moles, dark freckles, skin disease, birth marks, burns, lips, nipples, genital or anal areas, eczema, eyelashes, eyebrows, near the eyes, nasal or ear hair.

WARNINGS

- This is a sensitive laser scanning product. Care should be taken to avoid damage to the mechanism in the unit.
- Do NOT dismantle or repair. If you have any problems using the product, contact our Customer Care Department.
- Misuse of the unit can cause harm.
- Do NOT override any safety features or open the unit.
- Keep unit away from strong electromagnetic fields and magnets during use.

KNOW YOUR YES LASER

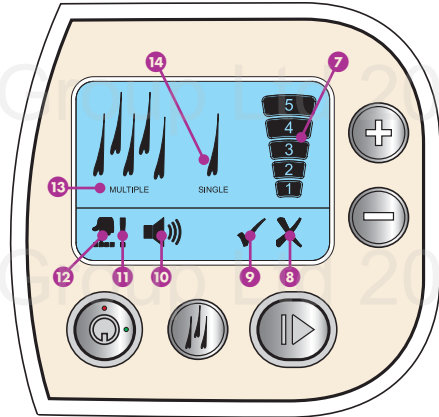
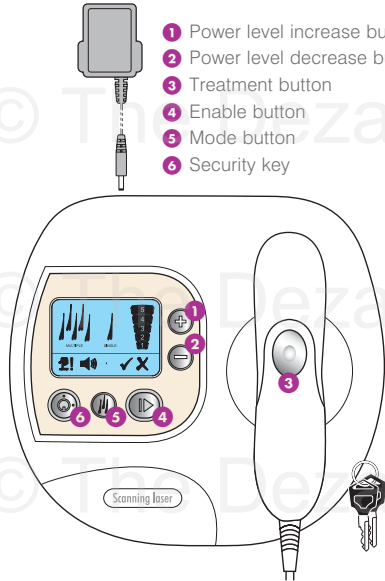

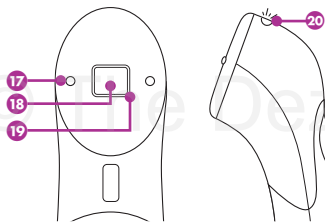

- 17 Touch pins
- 18 Laser aperture
- 19 Identification guide
- 20 White skin detect and treatment light



“Say goodbye to shaving, waxing and epilation...
YES!”



THE SCIENCE

LASER TECHNOLOGY



Yes Laser hair removal works by sending a laser beam to the hair follicle with enough energy to permanently disable the root without affecting the surrounding area. The result is permanent hair reduction. Simple to use, laser hair removal is suitable for unwanted face or body hair.

Skin and hair contains a natural pigment called melanin. The level of melanin in your skin is the primary determinant of your skin colour, and is responsible for causing skin to tan during sun exposure. Both skin and hair follicles contain different concentrations of melanin.

Lasers work by delivering an intense beam of light made up of a single wavelength. Yes Laser operates at a wavelength that selectively targets the melanin in the hair follicle, causing the hair follicle to absorb the laser energy.

The laser energy absorbed results in the rapid heating of the hair follicle. This heat destroys the cells responsible for hair growth. If adequate heating is achieved, the follicle is permanently disabled resulting in permanent hair reduction. The skin remains unaffected as it is essentially transparent to light in this wavelength range.

It is only possible to treat a hair follicle when there is a hair present and the best results are achieved when the hair is actively growing. For permanent hair reduction six treatments are recommended over a six month period. Occasional touch up treatments may be required for stubborn hairs.

What you should expect to feel?

You may feel individual hairs being treated, which is like a mild pin prick, and a slight warming of the area being treated. However, most people don't feel anything.

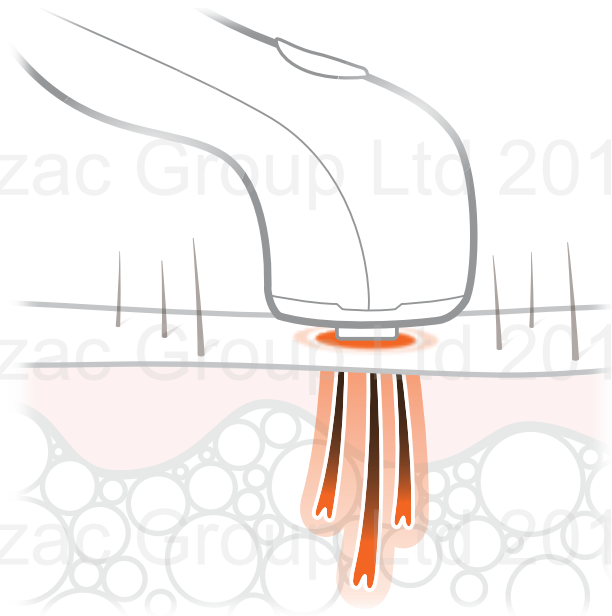

Who should not use Yes Laser?

Laser hair treatment is not suitable for the following skin tones or hair types:

- Afro-Caribbean or black skin complexions – the concentration of melanin in the skin is too high
- White or grey hair – insufficient melanin present in the hair.

The table on the following page can be used to establish whether laser hair removal is suitable, and if so, which level should be used.



SKIN TYPES AND POWER LEVEL GUIDE

Skin Colour	Tanning History	Maximum Power level
Very fair, "transparent"	Always burns, never tans	5 4 3 2 1
Fair	Always burns	Subject to patch test all 5 power levels can be used
Fair to light olive	Burns mildly	
Olive/Tanned	Rarely burns, tans with ease	3 2 1
Dark brown	Very rarely burns	NOT suitable for Laser treatment
Black	Never burns	

GETTING STARTED

PATCH TEST ✓

24 hours before treatment check for any reaction by treating a small area first.

The + and - buttons increase or reduce power levels. Treat several areas on each power level up to the maximum power level for your skin type (see table). If you feel any discomfort, the previous lower power level is the maximum power level you should use.

A slight redness may occur, but not always, within an hour of treatment. This localised redness is quite normal. However, if any redness remains after 24 hours this would indicate the power level selected was too high for your skin type. Use the next power level down during treatment.

NOTE: Skin colour varies on different areas of the body - you may find that you need different power level settings for different areas. Each area should be tested for the appropriate maximum power level.



How should I prepare my skin?

Laser hair removal does not require any special skin preparations, although you should always ensure your skin is clean. Laser hair removal is most effective on pale skin so we recommend avoiding sunbathing, sun beds and fake tanning if possible.

How should I prepare the hairs?

Shave the areas to be treated. This ensures the laser goes directly to the hair root and avoids hair burning on the surface.

What areas can I treat?

Most body hair can be treated using Laser Hair Removal - the most common areas are the face, underarms, legs, chest, back and bikini line. We do NOT recommend using Yes Laser on eyebrows.

Can I use laser hair removal on sensitive skin?

Yes, the laser reacts with the hair, so the surrounding skin will not be affected.

SECURITY FEATURES

Security key

The key allows the unit to be safely locked when not in use.

Insert the security key and unlock by turning clockwise so that when the security key is removed, the arrow lines up with the green dot.



Security code sequence

A security code sequence is required to use the unit:

- 1 Power level increase button (+)
- 2 Mode button
- 3 Power level decrease button (-)
- 4 Mode button

To change the security code sequence, see page 28.

SECURITY FEATURES

When the security code sequence is correctly entered, the **OK tick** and the **multiple hair mode** symbols will display. The unit will be on power level 1 and the **enable button** will flash. The lowest power level indicator light will also illuminate.

Note: The unit will go in to 'lockout' if the code is incorrectly entered. Turn the security key off, wait a few seconds and then turn the key back on. Re-enter the correct security code.

TREATMENT MODES

The treatment modes sequentially target single hairs in each treatment.

scan mode - multiple hair

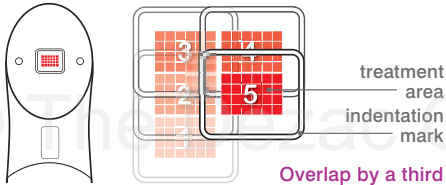

A small indentation mark will be left by pressing the unit down on the skin. Overlapping the indentation mark slightly with each treatment will ensure effective coverage of the treatment area.

single hair mode - single hair

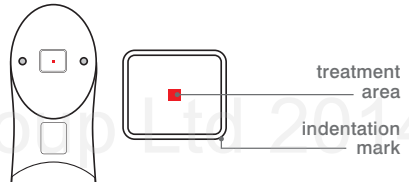

The single hair mode treats a small area in the centre of the indentation guide making it ideal for individual, problem hairs.

HOW TO USE

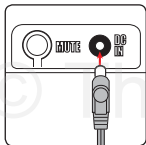

1. Connect mains adapter lead into the power socket at the back of the unit and plug into the mains.

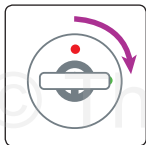

2. Use the security key to unlock the unit. See **security features** on page 15. The security code symbol will flash.

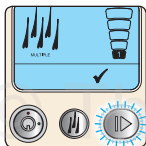

3. Enter the **security code sequence** from page 15. The **OK tick** and the **multiple hair mode** symbols will display. The unit will be on power level 1 and the **enable button** will flash.



4. Use the +/- buttons to select the correct power level for your skin type. Refer to the **power level guide** on page 12 to determine what level is suitable for your skin type.

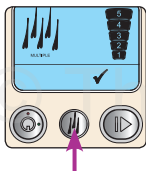

5. If you wish to select the **single hair mode**, press the **mode button**. (see **treatment modes** on page 17).

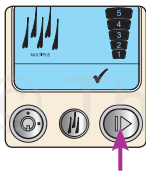

6. Press the enable button, the blue light around the button will stop flashing.

HOW TO USE

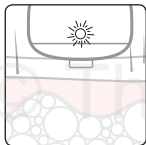

7. Place the wand onto the skin over the area you wish to treat ensuring the touch pins are in contact with the skin. Yes Laser has a skin detect feature; when the wand is correctly positioned a constant white skin detect/treatment light will illuminate at the front.

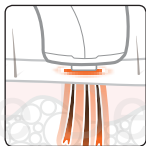
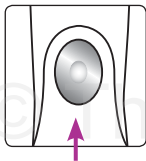

8. Press and HOLD the **treatment button** to start the laser treatment. The white treatment light will flash to indicate the laser treatment is in progress, the selected treatment mode will flash and the unit will beep repeatedly (this can be muted, see page 21). When the laser treatment is complete, the white light will stop flashing and the selected treatment mode will stop flashing. You can now move onto the next area of hairs to be treated. When moving the wand to the next area of hairs the touch pins must be removed briefly from the skin.

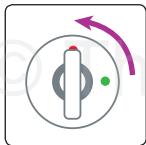

- Hint:** It is important to maintain skin contact during treatment. You may need to adjust the wand slightly to achieve good contact. Treatment may take up to 60 seconds to complete depending on the treatment level and mode used.
9. Turn off and lock the unit with the security key. Unplug the unit, remove the key and store separately. Store away from children.

Note: If no buttons are pressed after 20 minutes the unit will enter standby mode. To restart, turn key off and on again.

Note: If you experience unexpected behaviour of this product then it is possible some external electromagnetic interference is responsible e.g. electric motors/loudspeakers etc. You should remove this source and restart the product to restore full operation. At no time will the laser fire unintentionally.

Resetting after 'lockout'

If you experience a 'lockout' as indicated by the **error** symbol, simply reset by turning the unit off using the security key, waiting 5 seconds and turning the unit on again.

Mute button

Press the **mute button** on the back of the unit to turn off the sound. Press again to turn back on.



Note: This doesn't turn off warning sounds.

AFTERCARE ADVICE

How will my skin appear after the treatment?

Generally no perceptible changes will be apparent. A slight redness after treatment may occur but will normally fade over 24 hours. Any localised redness after treatment is caused by the destruction of the hair follicles and is quite normal. However, if any redness remains after 24 hours this would indicate you have selected too high a power level for your skin type. Please refer to the "Patch Test" section. Also note, any longer lasting redness will also disappear.

After laser hair removal is there anything to avoid?

Sun exposure or deep tanning should be avoided for at least a week. If the skin is exposed use a sunscreen. Also avoid using abrasive cleansers or skin peeling treatments. Avoid swimming in chlorinated water or using a hot tub for 48 hours. The chlorine in the water can result in itchiness.

Is there any aftercare routine I should follow?

If you wish, you can apply an unperfumed soothing lotion, an ice pack or wet towel to cool the treated area. Take care to keep the treated area particularly clean for 3 days. Ideally, use an anti-bacterial soap twice daily. When treating the underarms, avoid using antiperspirant deodorant for 2–3 days.

Can I use other hair removal methods between treatments?

Because Yes Laser needs a hair to be present in the follicle hair removal methods which pluck the hair, such as waxing, epilators and tweezing are NOT suitable for use between treatments. Bleaching hairs is also NOT suitable as it removes the pigment and renders the laser ineffective. Shaving, micro-dermabrasion discs and cream depilatories are ideal for use between treatments.

AFTERCARE ADVICE

How often can I repeat treatments?

As long as the hair follicle or surrounding skin is not red, sore or inflamed, treatment can be repeated after 24 hours. Most people wait 3–4 weeks between treatments to see which hairs have been shed and to identify new regrowth. The timing for follow on treatments is not critical. Choose a time which is convenient for you. Avoid excessive treatment on the same region at one time. This may cause reddening and swelling.

How many treatments will I need?

Laser hair reduction is generally considered to be effective and permanent after 6 treatments over a 6 month period. This varies from person to person and depends on the area you are treating, hair density, your hair's growth cycle and colour. Dark hair on fair skin responds to laser therapy best, but both dark and fair hair may take several treatments for long-term results. Some individuals may require more, and some fewer treatments, to achieve satisfaction. Initially with each treatment you will notice a gradual thinning/reduction of hair growth in the treated area. Women who suffer excessive hair growth due to male type hormones are likely to require long term maintenance.

When is laser hair removal most effective?

There are 3 phases in the hair growth cycle. Laser treatment is most effective when the hair is in the active growth phase. In a single treatment not all of the hair follicles will be in the active growth phase. To catch all hairs in the active growth phase a number of treatments are required.

THE HAIR GROWTH CYCLE

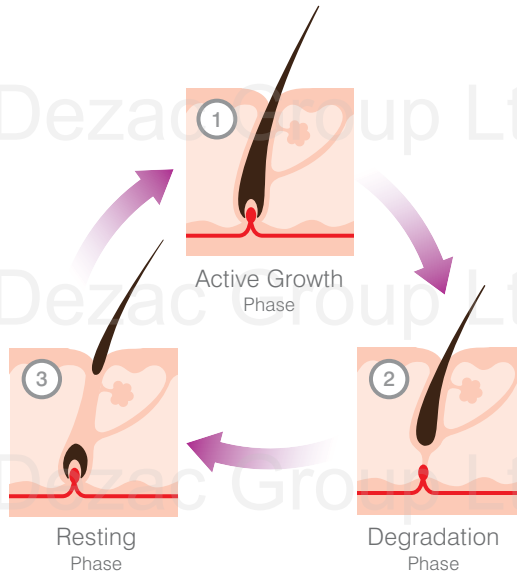

CLEANING THE LASER APERTURE



Periodically check whether there are any smoke deposits on the laser aperture. A build up of deposits will affect the efficiency of the laser. If you notice any deposits, switch the unit OFF and unplug the mains adapter. Then simply clean with a lint free cloth or cotton bud.

DO'S AND DON'TS

- ✓ After use always unplug the mains adapter and store out of reach of children.
- ✓ Only use this product with the mains adapter supplied.
- ✓ To protect the laser, do not store at temperatures exceeding 40°C.
- ✓ While unplugged, wipe the unit clean with a slightly damp cloth, regularly clean the touch pins and front face of the unit with a cotton bud, to ensure optimum laser output.
- ✓ Always store the unit and do not use it for any other purpose than intended.
- ✓ For laser efficiency, periodically clean the laser aperture with a lint free cloth or cotton bud, ensuring no fibres are left.
- ✓ If you experience unexpected behaviour of this product then it is possible some external electromagnetic interference is responsible. You should remove this source and restart the product to restore full operation. At no time will the laser fire unintentionally.
- ✗ Do NOT disassemble or repair. If you have any problems using the product, contact our Customer Care Department.
- ✗ Do not immerse the unit in water.

TROUBLESHOOTING

Problem	Solution
I have lost my keys.	Make a note of the serial number of your product from the base of the unit and contact Customer Care who will be happy to send you a replacement key.
The laser treatment is not starting when the treatment button is pressed.	Ensure the touch pins are making contact with the skin and you are in a well lit room.
No lights are working on the unit.	Ensure the adapter plug is turned on at the wall and the power lead is fully inserted in the bottom of the unit. If controls on the unit are left untouched for 20 minutes, the system will shut down. To restart, use the security key and enter the security code sequence.

CHANGING THE SECURITY CODE SEQUENCE

You can assign your own security code once you have unlocked the unit with the security key and entered the security sequence. BEFORE pressing any other buttons, press these buttons in the following order; power level increase (+) 3 times, mode button 3 times, power level decrease (-) 3 times and mode button 3 times.

The security code sequence and the power level 5 symbols will flash.

Enter your chosen security code sequence of four button presses (excluding the treatment and enable buttons). Each button press will be indicated on power levels 1 to 4. All five power levels will flash 3 times to confirm your security code has been accepted. Make a note of your security code for future reference.

If your chosen security code is not entered within 20 seconds the unit go in to 'lockout' and your security code will not be saved. To restart, turn the security key off and on, and then re-enter using the original security sequence. Pressing the treatment button will cause the unit to go in to 'lockout' and will not save the password.

RECOMMENDED FOR YOU

Deep Pore Cleanser

Uses micro-current technology to cleanse, moisturise, and refresh, leaving the skin invigorated, vibrant and deeply cleansed.



GUARANTEE

To register your two year guarantee online, visit: www.riobeauty.com/warranty_online.htm

DISPOSAL



The Waste of Electrical and Electronic Equipment (WEEE) Directive (2002/96/EC) has been put in place to recycle products using best available recovery and recycling techniques to minimise the impact on the environment, treat any hazardous substances and avoid the increasing landfill. This product is classed as Electrical or Electronic equipment so please ensure that at the end of the life of this product it is disposed of in the correct manner in accordance with local authority requirements. It must NOT be disposed of with household waste.

CUSTOMER CARE

If you have any questions, or if you experience any difficulties please call our Careline on: **01242 702345**

or email us at: online@riobeauty.com

To reorder additional accessories, please visit www.riobeauty.com or contact your local distributor.

© The Dezac Group Ltd 2014

© The Dezac Group Ltd 2014

© The Dezac Group Ltd 2014



CLASS 1 PRODUCT
CONTAINING
CLASS 3B LASER



LASER SAFE[®]
TECHNOLOGY

© The Dezac Group Ltd 2014

© The Dezac Group Ltd 2014

© The Dezac Group Ltd 2014

UK



www.riobeauty.com

Rio, Dezac and Yes Laser Hair Remover are trademarks of The Dezac Group Ltd © The Dezac Group Ltd 2013
Manufactured by The Dezac Group Ltd PO Box 17, Cheltenham, England GL53 7ET

1-IN-LAHC6-UK/1.0