

## User Manual

- Please read the operating instructions carefully before using this unit and keep it properly.
- In case of any printing or translation error, we apologize for the inconvenience. Please contact us as soon as possible.

### Intellight Vacuum Cleaner

D2-001

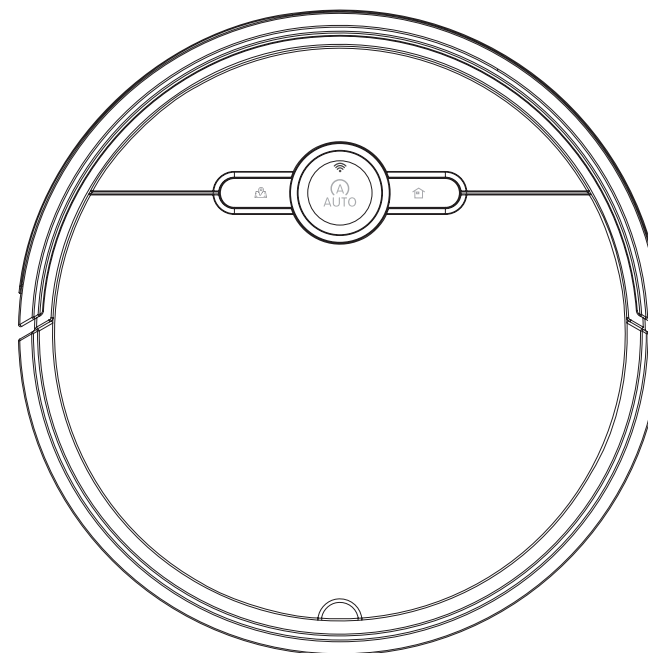

Picture for reference only

## Contents

1. Safety Precautions .....	2
2. Product Composition .....	5
3. Instruction Manual .....	8
4. Charging Stand Instructions .....	13
5. Product Maintenance .....	14
6. Product Specifications .....	16
7. Remote Control Instructions .....	17
8. WiFi Connection .....	19

## 1. Safety Precautions

### 1.1 Safety Responsibility Regulations

Although children over 8 years old and people with physical, sensory or mental dysfunction, or people without relevant experience can use this product, they need to use it in a safety way under supervision and direction. They should know health risk behaviors and can't clean & maintain this product without supervision.

#### Warning:

1. Do not touch the electronic components, batteries or charging stand of the robot. Users are not allowed to maintain the internal components of the product.
2. Production maintenance needs authorized maintenance personnel to operate. Please make sure that the rated power supply voltage of the charging stand meets the standard plug voltage.
3. Product are not allowed to work under the surroundings without any fence in order to avoid falling down which may cause severe damage, property loss or personal injury.

### 1.2 Safety Rules

- Before operating the robot vacuum cleaner, please read all the safety precautions and operation instructions
- Please pay attention to all warnings on the battery, power adapter, robot and user instructions.
- Please follow all operating instruction manual.
- The harm caused by wrong operation and the degree of damage are described as follows.

### 1.3 Product Safety Issues

#### Warning

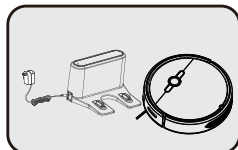

⚠ This product is limited to the original battery charging stand and adapter, otherwise it may cause product damage, electric shock or fire caused by high voltage. Before use, please place the rechargeable seat on the wall, and do not place any articles within 2 meters in front and 1 meter in left and right.

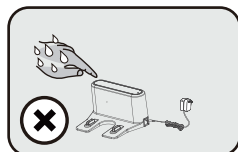

⚠ Please do not use this product if the main engine and accessories are damaged. Contact our after-sales service department. No one is allowed to dismantle, repair or modify the product except the maintenance technicians designated or authorized by the company.

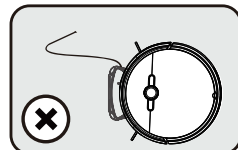

⚠ Do not touch the power plug or product when the hand is wet, otherwise electric shock may be caused.

⚠ Do not use the product in no protective fence situation, in order to avoid accidental falling of vacuum cleaner and then person injury

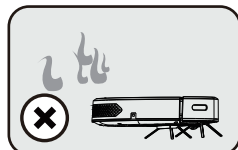

⚠ Do not use the power cord to drag or move the product. Do not over twist, bend or place heavy objects on the power cord.

⚠ Do not let the product close to the fire source or the inflammable, explosive and corrosive materials.

⚠ Keep away from direct heat, and any corrosive or explosive materials.

#### Warning

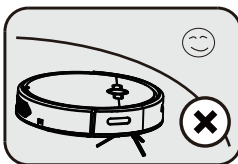

Indoor use only

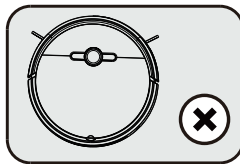

Do not sue for spilled liquids

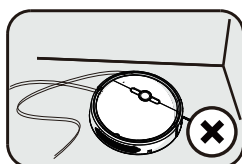

Before use make use extra cording is contained and kept clear of vacuum operation to avoid any interference

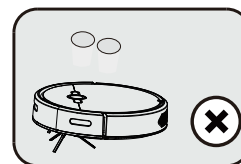

Please remove all vulnerable items before use.

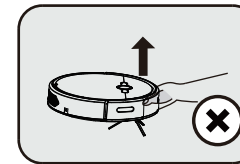

Do not hold the front shell to lift the vacuum cleaner. Please use both hands to hold the machine body to lift the vacuum cleaner.

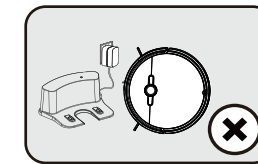

It is forbidden to use non-original adapter and charging stand to charge the machine, so as to avoid damage to the machine.

### 1.4 About the Safety of Children

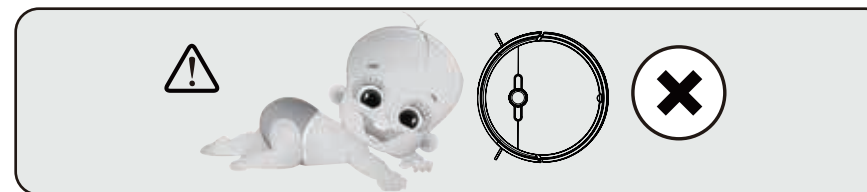

\* Children are not allowed to use this product alone.

\* Children are not allowed to play with the packaging bag of the product, otherwise it may cause suffocation.

### 1.5 About Batteries

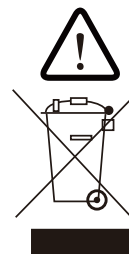

1. This product is only suitable for the original battery provided by the manufacturer;
2. The battery must be taken out when the product is discarded;
3. If you need to replace the host battery, please contact our after-sales service department. If you replace the battery with the wrong model, it may lead to safety accidents;
4. In case of battery leakage, if the liquid sticks to the skin or clothes, wipe it with dry cloth immediately. The discarded batteries shall be sent to the recycling station or designated maintenance point, and shall not be discarded.

## 2.Product Composition

### 2.1 Package List

Serial Number	Describe	Quantity
1	Robot Vacuum Cleaner (including battery)	1
2	Charging Stand	1
3	Remote Control	1
4	AC Power Adapter	1
5	Mop Cloth	1
6	User's Manual	1
7	Side Brushes	4

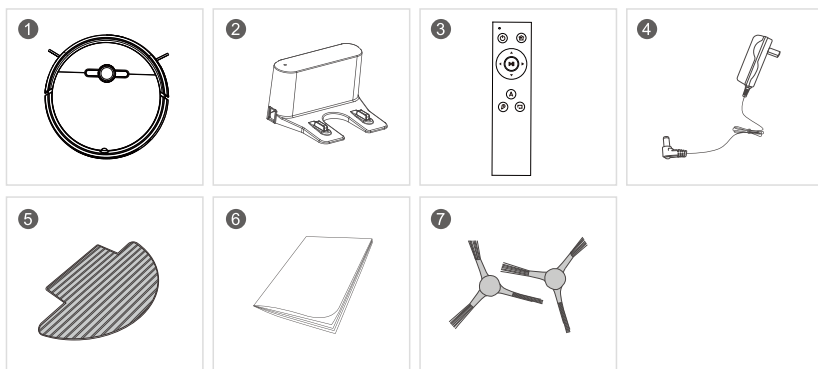

#### Kindly Reminder

1. Batteries are installed in the machine
2. HEPA filter has been installed in dust box

### 2.2 Main Engine Diagram

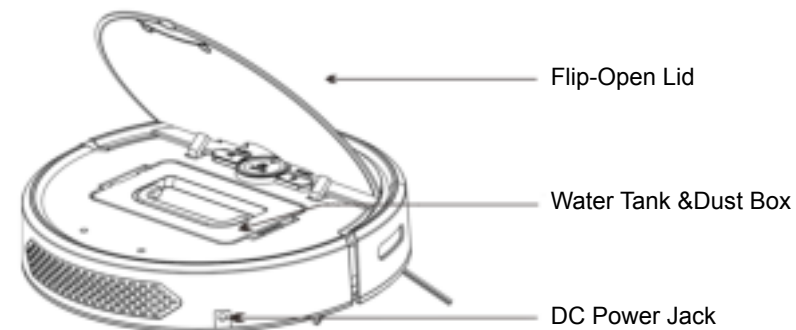
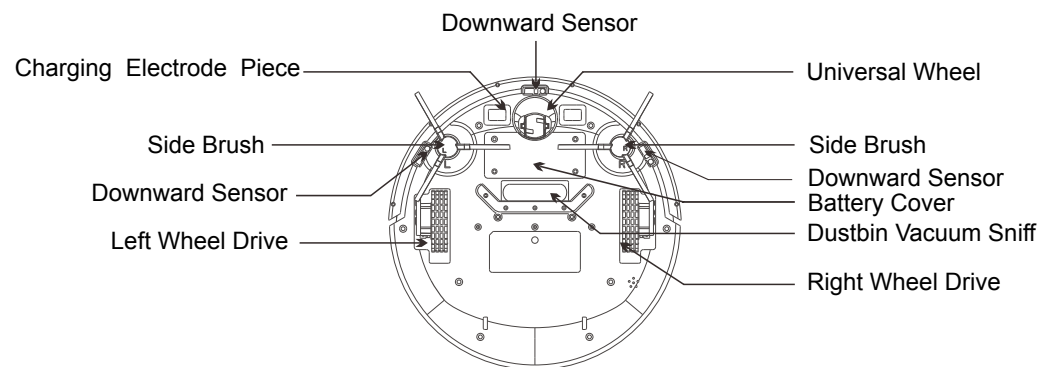
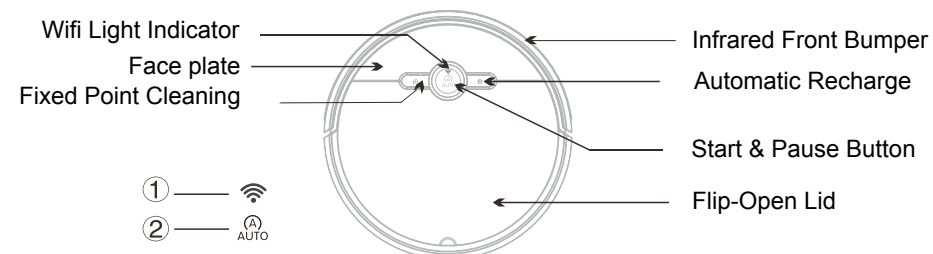

### 2.3 2 in 1 Water Tank & Dust Box Diagram

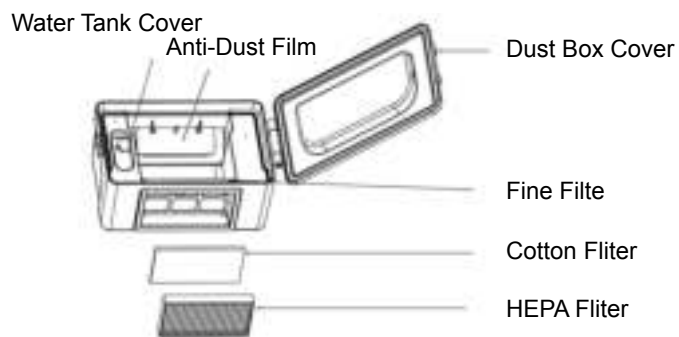

### 2.4 Diagram of Charging Stand

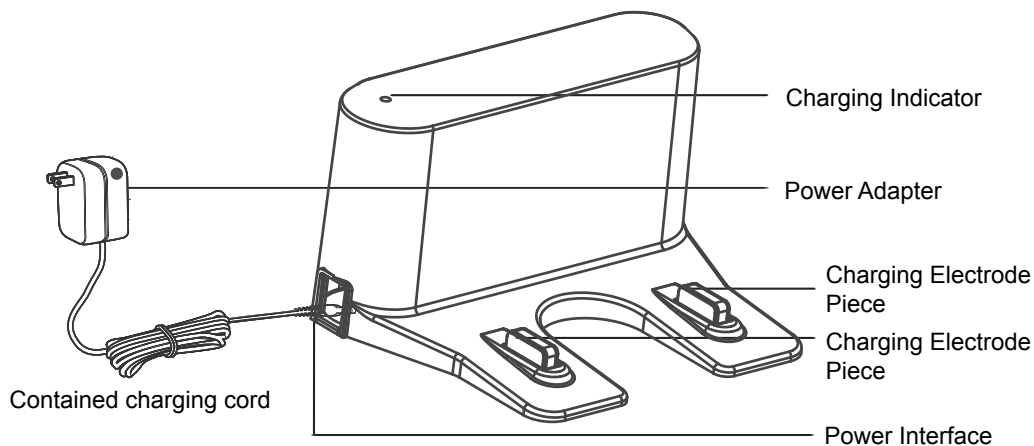

### 3. Use of Products

\*Note: Before use, Please remove the protective bolt and tidy up the small objects or obstacles in the room, especially the wires and other entanglements which need to be cleaned.

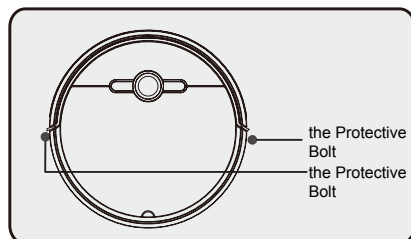

### 3.1 Application Scope of the Product

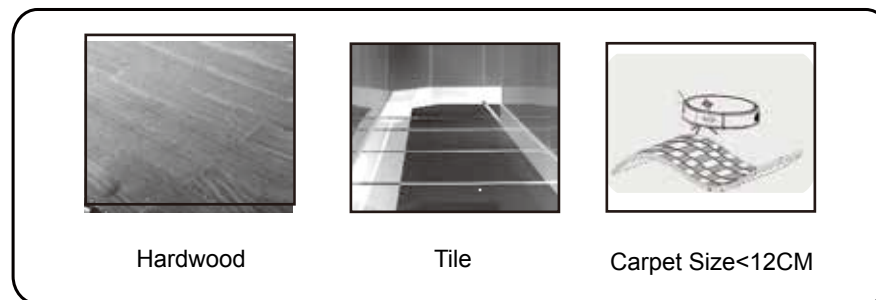

#### Scope of Inapplicability

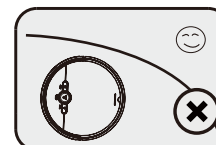

\*It is not suitable for use in extremely hot (+ 60 °C) or extremely cold (- 5 °C) environment.

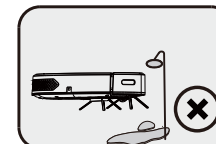

\*This product is only suitable for indoor.

\*It can not be used in the places without protective fence to avoid personal injury caused by accidental fall of the product.



\*Do not use in humid or flammable, explosive and corrosive environment.

\*Do not allow the product to absorb cigarette butts or matches that have not been extinguished.

\*It can't be used to absorb toner and color pan used in laser printer and copier. These substances can cause fire.

\*Do not use to absorb sharp objects, such as glass, nails, etc., to avoid product damage.

#### 3.2.1 Side Brush Installation



Press down the side brush after aligning square hole with the square axis. Installation is done after hearing the sound.

### 3.2.2 Mop Assembly and Use Instructions



- A. Put the robot with its back side up  
B. Remove protective sticker to reveal the adhesive side of the Velcro



- A. Stick completely the two strips in the position shown in figure  
B. Sticky side down, keep the rear face of the robot clean, free from dust and water stain



- A. Glue the mop to the back as shown in the picture  
B. It can be reused after washing mop



- A. Note: Always wring out the mop slightly after wetting it with water, then stick it on the back of the robot to avoid excessive water stains.

### 3.2.3 Dust Box Installation

- Take out: hold the handle by hand and pull it out. Loading: put the dust box into the flat.

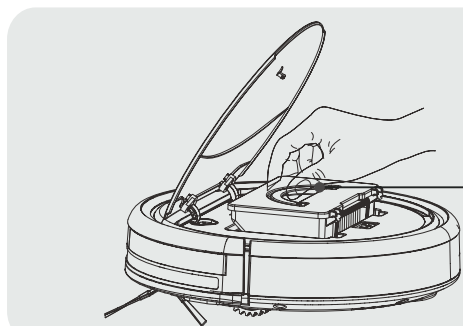

Cover Handle for the Dust Box

Note:

1. Please clean the filter screen of the dust box before use. If the dust collection effect is not good, please check whether there is too much garbage in the dust box and clean it in time.

2. The water tank is autodoping type. Water will flow slowly from the dust box's plughole when filled with water.

3. When the product is not working, please remove water from the water tank to avoid water logging.

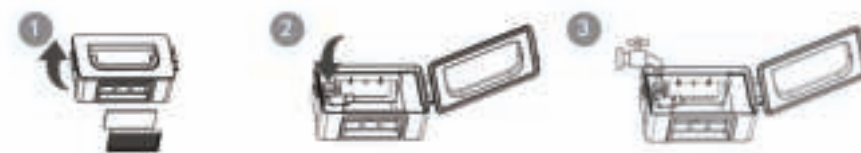

1. Take out the cotton filter and HEPA filter, and open the dust box. 2. Open the water tank lid 3. Put water in the water tank



4. Cover the water tank lid 5. Cover the dust box, put the cotton filter and HEPA filter 6. Put the dust box into host

### 3.3 Machine Working Mode

#### 3.3.1 On/Off

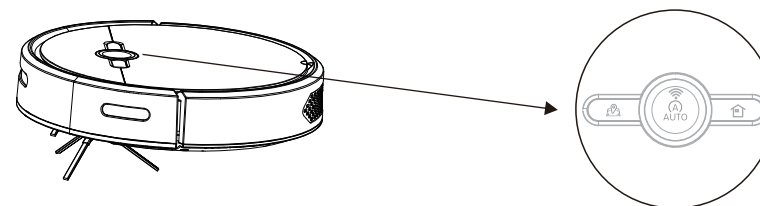

A Long press the "AUTO" button in the off state, the buzzer alarms once along with three indicator lights up, then a system returns standby.

#### 3.3.2 Standby Mode

When the machine is in standby mode, There are 6 different operation to next step:

- 1.If the machine is not operated, it will automatically shut down after 5 minutes
- 2.Short press the "AUTO" button, the buzzer will alarm once and the machine will enter the automatic cleaning mode.
- 3.Short press the "🏠" button, the buzzer will alarm once and the machine will enter the fixed-point cleaning mode.
- 4.Short press the "🔌" button, the buzzer will alarm once and the machine will enter the automatic recharge mode
- 5.Long press the "AUTO" button for 3 seconds, the buzzer will alarm twice and the machine will shut down.
- 6.Plug the charger into the DC power socket, the buzzer will alarm once ,the "AUTO" light will flash, and the machine will enter the direct charging mode.

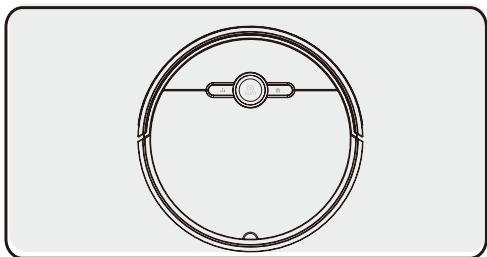

### 3.4 Automatic Cleaning Mode

When the machine is in automatic cleaning state, the machine starts to clean. The automatic cleaning mode is suitable for cleaning the entire home environment. The machine works according to the internal cleaning path, and it avoids obstacles and steps. The machine can perform the following operations in this working mode:

- 1.Press any button on the machine, the buzzer will alarm once, stop working and enter the standby mode.
- 2.If the battery power is low, the buzzer alarms 3 times, then the machine will enter the automatic recharge mode.
- 3.When a fault is detected, it enters the error mode and the machine alarms (see the fault mode details)

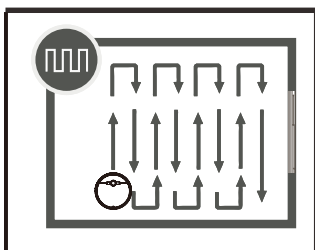

Automatic Cleaning Mode

### 3.5 Fixed Point Mode

When the machine is in the fixed-point cleaning mode, the fixed-point LED light is on. Without any obstacles, it will automatically back to be recharged mode after finishing the fixed point cleaning work. This mode is just used for small area cleaning

The machine can perform the following operations in this working mode:

- 1.Press any button on the machine, the buzzer will alarm once, and the machine will enter the standby mode.
- 2.When a fault is detected, it enters the error mode and the machine alarms (see the fault mode details)

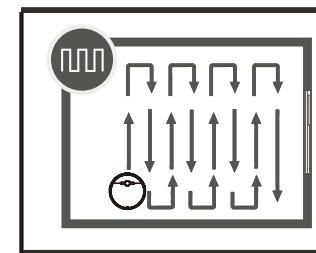

### 3.6 Automatic Recharge

Automatically go back charging stand to recharge when power is lower than 20 percent. When the machine is in charging mode, the LED light of automatic cleaning mode flashes, indicating that it is charging, and the light stop to flash and keep on when the machine is fully charged.

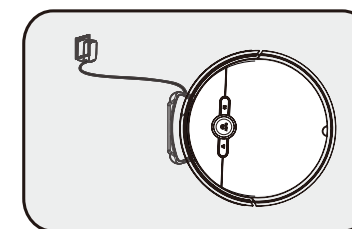

When the machine is in this model .There are 3 optional back to auto cleaning mode after fulll charged: Press the Auto button on the machine. "A" button on the remote or "auto" icon on the phone app.

It is recommended to maintain the product after used

### 3.7 Troubleshooting

In the trouble situation, machine will stop working, Auto Cleaning light, Fixed Port Cleaning light will on simultaneously, and buzzer will alarm, the machine will be off if have not any manual operation. Different troubles as belows:

No.	Failed Mode	Failed Prompt	Troubleshooting
1	Left Anti-Drop Sensor Failed	LED flashes once, and buzzer alarms once.	Check whether the sensor lens on the left side of the back machine is dusty and clean it.
2	Front Anti- Drop Sensor Failed	LED flashes twice, and buzzer alarms once.	Check whether the sensor lens in front of the back machine is dusty and clean it.
3	Right Anti- Drop Sensor Failed	LED flashes 3 times, and buzzer alarms once.	Check whether the sensor lens on the right side of the back machine is dusty and clean it.
4	Right Anti-Collision Sensor Failed	LED flashes 4 times, and buzzer alarms once.	Check whether the right of bumper housing is jamming and slight pata
5	Left Anti-Collision Sensor Failed	LED flashes 5 times, and buzzer alarms once.	Check whether the right of bumper housing is jamming and slight pata
6	Left Wheel Over Current	LED flashes 6 times, and buzzer alarms once.	Check whether the left wheel is wrapped or stuck.
7	Right Wheel OverCurrent	LED flashes 7 times, and buzzer alarms once.	Check whether the left wheel is wrapped or stuck.
8	Abnormal Left wheel	LED flashes 8 times, and buzzer alarms once.	Check whether the right wheel is wrapped or stuck.
9	Abnormal right wheel	LED flashes 9 times, and buzzer alarms once.	Check whether the right wheel is wrapped or stuck.
10	Motor Failed	LED flashes 10 times, and buzzer alarms once.	Check whether there are foreign objects inside the fan
11	Side Brushes Failed	LED flashes 11 times, and buzzer alarms once.	Check whether the left and right brushes are wrapped.
12	The machine get stuck	LED flashes 13 times, and buzzer alarms once.	Check whether the machine is wrapped or stuck by oreign objects

## 4. Charging Operation

### 4.1 Charging Stand Placement

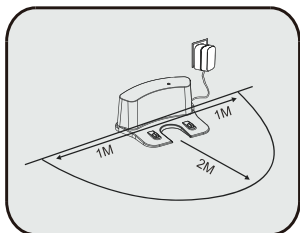

In order to facilitate the machine to find the charging stand in time, it is suggested that the charging stand should be placed on the wall stably, and no articles should be placed within 2 meters in front and 1 meter in the left and right respectively

### 4.2 Manual Charging

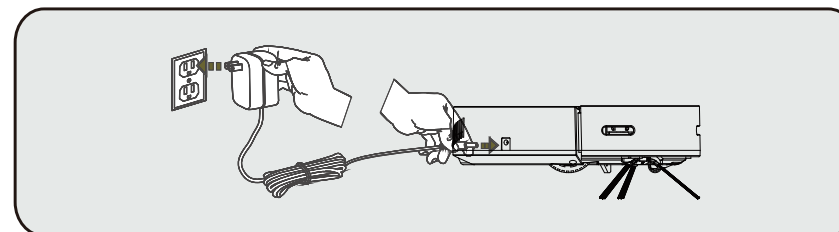

Connect the power adapter directly to the machine and connect the other side to the power supply.

1. When charging for the first time, please charge for 12 hours.
2. During daily use, please store the machine on the charging stand and ensure that the charging stand is connected to the power supply.
3. If you do not use the machine for a long time, please fully charge the machine, turn off the machine and store it in a ventilated and dry place.

## 5. Product Maintenance

### 5.1 Cleaning Side Brush

Clean the side brush when it becomes dirty. If it is damaged, it can be replaced.

- ① Cleaning Brush  
Remove the side brush and wipe with a clean cloth.
- ② Clean the Universal Wheel  
Clean the universal wheel to reduce hair entanglement.

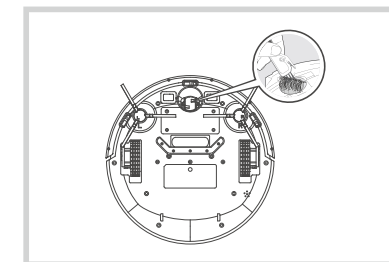
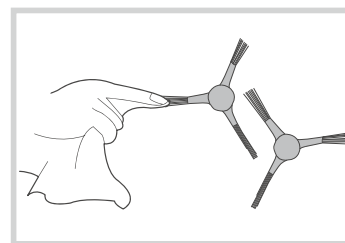



## 5.2 Cleaning of Dust Box and Filter Screen

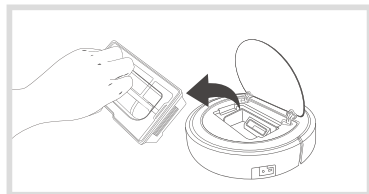

Take out the dust box.

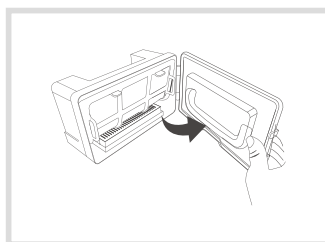

Open the dust box and clean up the garbage.

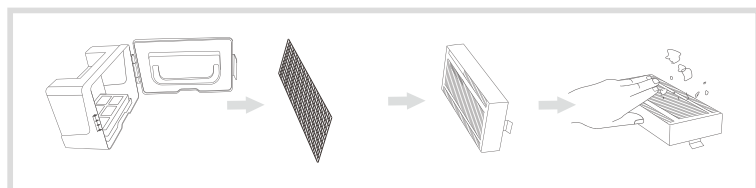
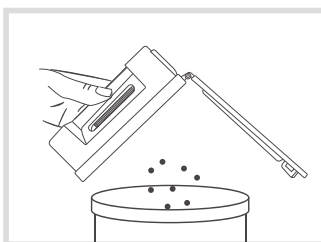

Remove the filter material components and filter the HEPA efficiently. It is not recommended to wash the HEPA with water, but to remove the dust with a light tap.



Wash the dust box and primary filter screen, dry the dust and filter material components, and keep them dry to ensure their service life.

## 5.3 Cleaning of Anti-Drop Sensor and Charging Electrode

Gently wipe the sensor and electrode piece with soft cloth.

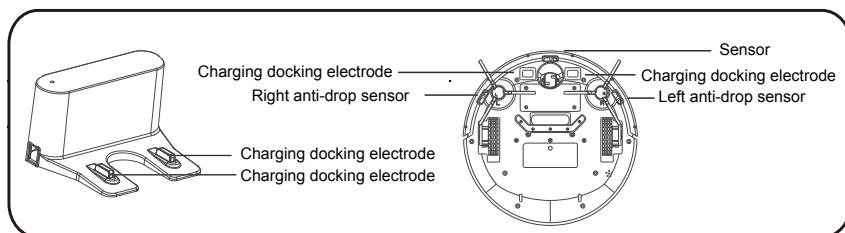

\*Kindly reminder: Please remember to clean the charging docking electrode in the base if there is any lint or debris.

## 5.4 Clean the side brush

- Use the cleaning brush to clean the garbage on the side brush. If there is more hair on the side brush, you can use scissors to cut the hair carefully, and then clean it.

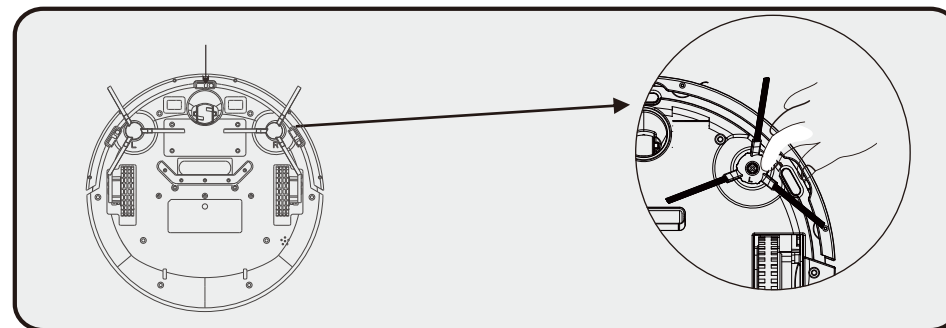

- Installation Steps: Align the hole position of the base installation while sweeping, and press down to hear the "snap" sound, indicating that the side sweeper is installed in place.
- Disassembly Steps: Grasp the brush at both ends of the brush and pull it out gently.

### Warm Tips :

Before using the machine, please check whether the side brush has been assembled, otherwise the normal cleaning of the vacuum cleaner will be affected.

## 6. Specifications

Working Voltage	7.4V
Rated Power	25W
Rechargeable Battery	Lithium Battery
Battery Capacity	4400mAh
Charging Time	About 4~5 Hours
Working Hours	>120mins
Operating Temperature Range	-10°C~45°C
Operating Humidity Range	<90%RH
Capacity of Dust Box	400ML
Capacity of Water Tank	150ML
Dimensions (L x W x H)	320*320*78mm

## Remote Control Instructions

### Remote Control Diagram

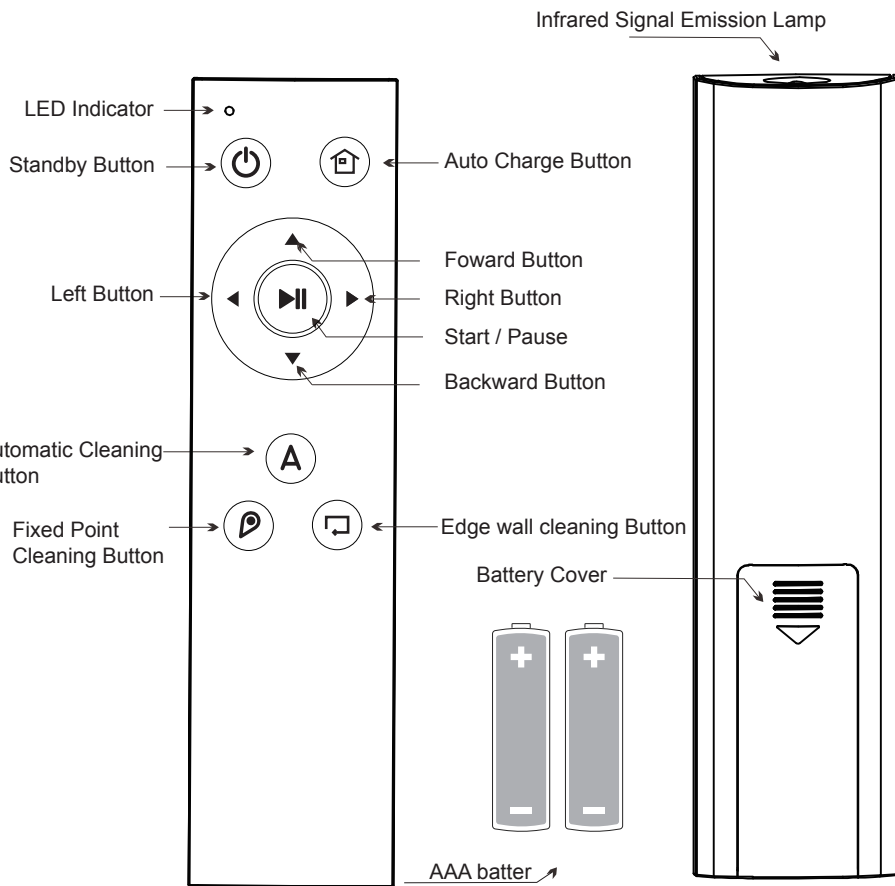

## Remote Instructions

### Troubleshooting

The following are the causes of the faults.

Number	Fault Phenomenon	Cause of Failure	Solution
1	The LED indicator does not on red.	No battery or reverse polarity	Reinstall or replace the battery
2	Low remote control sensitivity	Low battery	Replace the battery
		Something is blocking the remote control signal	Confirm to use in open space
3	Button Failure	Foreign matters or water in the button	Remove foreign things
		Low battery	Contact the manufacturer

Component Category	Harmful Substances					
	Pb And its compounds	Hydrargyrum (Hg) And its compounds	Cadmium (Cd) And its compounds	Hexavalent chromium (CrVI) And its compounds	Polybrominated biphenyls (PBB)	Polybrominated diphenyl ether (PBDE)
Plastic parts	o	o	o	o	o	o
Hardware (4)	X	o	o	o	o	o
Host Circuit Modular	X	o	o	o	o	o
Battery	o	o	o	o	o	o
Plug power line (metal)	X	o	o	o	o	o

o:It indicates that the content of the hazardous substance in all homogeneous materials of the part is below the limit specified in the current effective version of GB /t26572.  
X:It means that the content of the hazardous substance in at least one homogeneous material of the component exceeds the limit requirements of the current effective version of GB /126572, and there is no mature alternative in the industry, which meets the environmental protection requirements of RoHS directive of the European Union.

#### \* Warm Reminder

- \* If the unit will not be used for an extended period of time, please remove and store the battery in a cool location with low humidity
- \* In case of battery leakage, remove batteries, wipe the unit's battery compartment, and wash your hands.
- \* Do not allow water to enter the remote control. Do not use it in humid environment for a long time.

## Robot Vacuum Cleaner Wifi Instructions

EN

1. Scan below QR code and download App : Tuya Smart (Suitable for Apple system and Android system)



2. Register account and log in

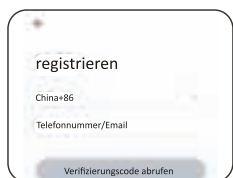

3. Enter the interface and select Add Machine



4. Click the +icon in the upper right corner, and click "small home appliance" to select "Robot Vacuum (Bluetooth+WiFi)"



5. Select the 2.4GHz WiFi network and enter the password, click "Next"



6. Long press the "AUTO" button on the machine, the LED flashes and turns on, and enters standby mode. In standby mode, long press the fixed point button till buzzer alarms twice, the WiFi light flash and indicating robot ready to be connected.

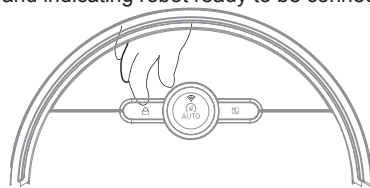

7. Confirm that the machine enters the distribution network mode and click "next".



8. The mobile phone shows that the addition is successful during the WiFi connection, click "Finish" to enter the operation interface.



9. After the WiFi is connected successfully, click the modify icon on the right side of the device to modify the machine name



10. Wi-Fi APP interface button instructions

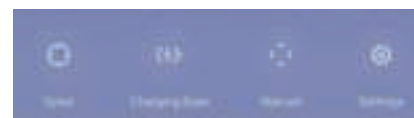

- 1). Cleaning switch (on/standby)
- 2). Standby
- 3). Automatic (automatic cleaning mode)
- 4). Edge (edge cleaning mode)
- 5). Fixed-point (fixed-point cleaning mode)
- 6). Recharge (automatic charging)
- 7). Manual mode (start/pause or direction)
- 8). Setting (search for robot vacuum/timer)

11. Appointment Function

The appointment function is similar to the alarm clock on the phone. After setting the cleaning time, the machine will automatically enter the automatic cleaning mode at the setting time as long as the machine is in standby or charging on the recharging stand.

EN



1

2



3

4

A. Click "Settings" to enter the timing interface (as shown in Figure 1,2)

B. Click the time you want to set, such as 16:16, which can be repeated one or more times. Select the working mode of appointment and save it (as shown in Figure 3).

C. Click saving button in the upper right corner (as shown in Figure 3).

D. If you need to cancel the setting time, click the switch on the right. If it disappears, the appointment of the day will be canceled.

E. When the machine reaches the setting time, it will run automatically